

* NOTE: ALL DIMENSIONS, DIMENSIONS, LOCATIONS & CONDITIONS MUST BE VERIFIED "IN-FIELD". ALL DIMENSIONS SUPERSEDE SCALE.

SITE PLAN
 1"=30'-0"



PROJECT DATA

OWNER: CHEERS BELGARD
 5459 OCCOTILLO DRIVE
 PROJECT ADDRESS: YUCCA VALLEY, CA, 92384
 PROJECT NUMBER: 2019-001
 LEGAL DESCRIPTION: 5459 OCCOTILLO DRIVE, YUCCA VALLEY, CA, 92384
 5.141 HWY 1 NE 1 SEC 20 TP 1N R 6E W E 301 AND 302 ACRES RESERVATION OF RECORD 114 ADM. ASSESSMENT CONTROL NO. 008400100-0000 BUILDING DATA:
 R341 OCCUPANCY GROUP
 TYPE YEAR CONSTRUCTION
 PROFILES: 1
 PREP BY: [redacted]
 DATE: 10/1/2019
 (SHEET REFERENCE) 1"=30' FT. TOTAL SPACE 2310 SQ. FT.

VICINITY MAP

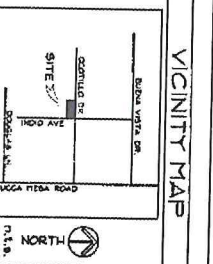

SCOPE OF PROJECT

- 1) FULL RESERVATION - NO NEW WORK
- 2) DESIGN REVIEW
- 3) ADD TO EXISTING SERVICE PLANS WITHIN SUB
- 4) PERMIT NO. GRABER PARKING SPACE @ 100'

SHEET INDEX

SHEET	DESCRIPTION
11	SITE PLAN TITLE SHEET
A1	FLOOR PLAN, EXISTING & PROPOSED
A2	ROOF PLAN, EXISTING & PROPOSED
A3	ELEVATIONS - EXISTING & PROPOSED
E1	ELECTRICAL PLAN
T1	MHC & FURNISHING PLANS & NOTES
A41	RAMPOUTRY DETAILS
SITE	
S-1	FOUNDATION PLAN
S-2	GENERAL NOTES, STANDARD DETAILS
S-3	DETAILS

CONSULTANTS

ARCHITECTURAL PROFESSIONAL
 FRED SEBU - FRED SEBU ENGINEERS
 1000 CALIFORNIA AVE - SUITE 100
 RIVERSIDE, CALIFORNIA 92507
 TEL: 951-509-1122
 WWW.FREDBEUBUILDING.COM
 JOHN G. HENDERSON CONSULTANT
 41000 FORTNEY AVE STE. 47
 RIVERSIDE, CALIFORNIA 92518
 TEL: 951-509-1122
 WWW.HENDERSONCONSULTANTS.COM
 BILL DAVIS CONSULTING - 38012Z
 YUCCA VALLEY CONSTRUCTION, INC.
 YUCCA VALLEY, CA 92384
 PHONE: 760-600-0007

DRAWN BY
 DRS
 DATE
 DEC. 23, 2020
 SCALE
 AS SHOWN
 PROJECT
 DELGADO-#274
 SHEET

 OF ___ SHEETS

DESIGNERS
C
S
 DCS DESIGNERS
 P.O. BOX 926
 DESERT HOT SPRINGS, CA.
 92240 PHONE: 760.389.2660

SHEET TITLE
 SITE PLAN
 TITLE SHEET
 PROJECT DATA

FOR THE RESIDENCE OF:
 CHERISH DELGADO
 58689 OCOTILLO DRIVE
 YUCCA VALLEY, CA. 92284

REVISIONS	BY
△ 01/19/2021	DRS
△ 02/26/2021	DRS
△ 02/26/2021	DRS
△	
△	
△	
△	

DCS DESIGNERS EXPRESSLY RESERVES ALL RIGHTS OF INVENTION & COPYRIGHTS TO ANY AND ALL DEVICES & PLANS THEREIN & PLANS ARE PROPERTY OF DCS DESIGNERS. ANY REPRODUCTION, REPRESENTATION OR USE OF THESE DEVICES & PLANS IN ANY FORM, IN PART OR IN WHOLE, WITHOUT WRITTEN PERMISSION, IS STRICTLY PROHIBITED. USE AND ALL COPYRIGHTS, PATENTS AND TRADEMARKS SHALL BE PROTECTED. ALL DEVICES & PLANS, THEIR APPLICATIONS AND ALL INSTRUMENTS, ARE TO BE THE COMPLETE AND FULL RESPONSIBILITY OF THE OWNER AND BUILDER. WRITTEN AGREEMENTS ON THESE DRAWINGS SHALL HAVE PRECEDENCE OVER SCALES OR DIMENSIONS. ALL CONTRACTS AND TRADES SHALL BE VOID AND BE RESPONSIBLE FOR ALL DIMENSIONS AND QUALITY CONDITIONS.