

# IN THE TOWN OF YUCCA VALLEY, COUNTY OF SAN BERNARDINO GRADING PLAN AND FUGITIVE DUST AND EROSION CONTROL PLAN FOR APN 0621-022-04-0000

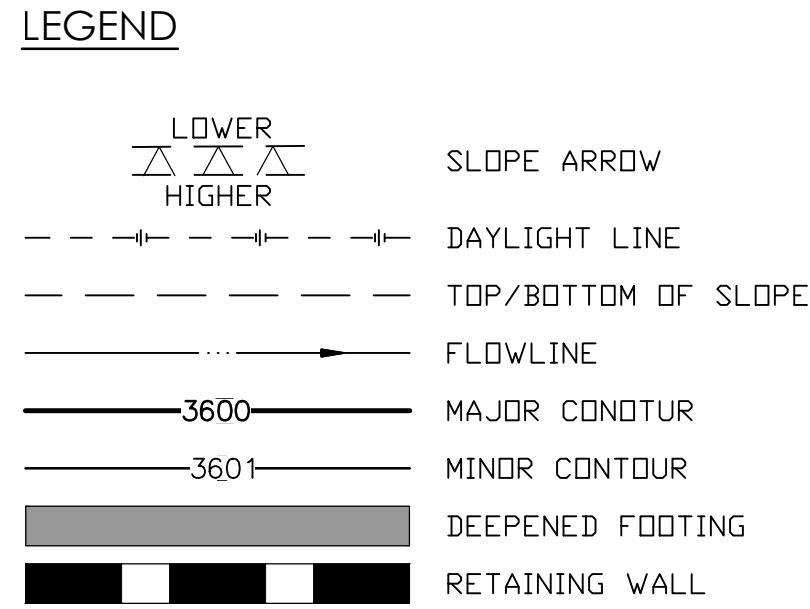
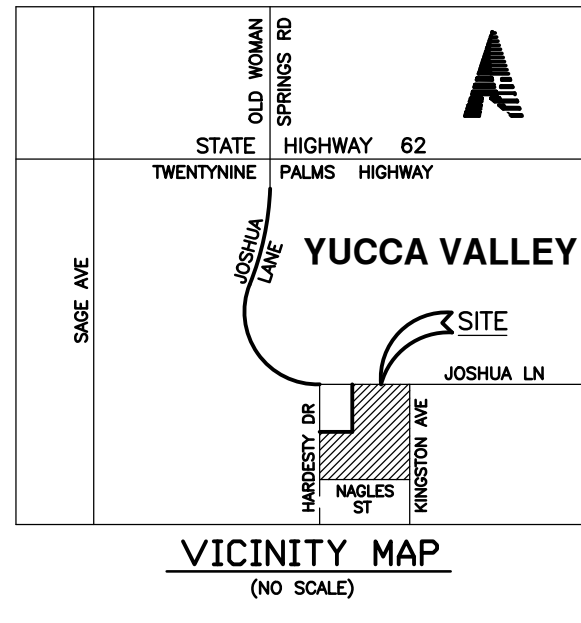

**UTILITY COMPANIES**

|                        |   |
|------------------------|---|
| <b>WATER</b>           | HI-DESERT WATER DISTRICT<br>954359 PALMS HWY<br>YUCCA VALLEY, CALIFORNIA 92284<br>ATTENTION: MARK BAN<br>PHONE: (760)365-8333                 |
| <b>TELEPHONE</b>       | VERIZON<br>295 N. SUNRISE WAY<br>PALM SPRINGS, CALIFORNIA 92262<br>ATTENTION: LARRY MOORE<br>PHONE: (760)778-3603                             |
| <b>POWER</b>           | SOUTHERN CALIFORNIA EDISON<br>6999 OLD WOMAN SPRINGS ROAD<br>YUCCA VALLEY, CALIFORNIA 92284<br>ATTENTION: JOHN D'ELLE<br>PHONE: (760)365-5449 |
| <b>GAS</b>             | THE GAS COMPANY<br>7320 PINNACLETOWN ROAD<br>YUCCA VALLEY, CALIFORNIA 92284<br>ATTENTION: DARCYL WHITLEY<br>PHONE: (760)778-0908              |
| <b>CABLE</b>           | TIME WARNER CABLE<br>83-473 AVENUE 45<br>INDIO, CALIFORNIA 92201<br>ATTENTION: LEE HOBSON<br>PHONE: (760)774-6007                             |
| <b>SEWAGE DISPOSAL</b> | SEPTIC TANKS AND SEEPAGE PITS   |

**LEGAL DESCRIPTION**

ALL THAT CERTAIN REAL PROPERTY SITUATED IN THE INCORPORATED TOWN OF YUCCA VALLEY, COUNTY OF SAN BERNARDINO, STATE OF CALIFORNIA, DESCRIBED AS FOLLOWS:

THE EAST HALF OF THE NORTHWEST QUARTER OF THE NORTHWEST QUARTER OF THE SOUTHWEST QUARTER AND THE SOUTH HALF OF THE WEST HALF OF THE NORTHWEST QUARTER OF THE SOUTHWEST QUARTER OF SECTION 12, TOWNSHIP 1 SOUTH, RANGE 5 EAST, SAN BERNARDINO MERIDIAN, AS SHOWN IN GRANT DEED RECORDED AUGUST 26, 1999 AS DOCUMENT NO. 19990362587.

TOGETHER WITH PARCELS 1 AND 3 OF PARCEL MAP 5375 BDK 55 OF PARCEL MAPS AT PAGES 95 THROUGH 96, INCLUSIVE, IN THE OFFICE OF THE COUNTY RECORDER OF SAID COUNTY, PURSUANT TO NOTICE OF MERGER RECORDED AUGUST 11, 1999 AS INSTRUMENT NO. 99-340403, OFFICIAL RECORDS OF SAID COUNTY.

ALSO TOGETHER WITH A PORTION OF THE WEST HALF OF THE NORTHWEST QUARTER OF THE NORTHWEST QUARTER OF THE SOUTHWEST QUARTER OF SAID SECTION 12, AS SHOWN IN GRANT DEED RECORDED APRIL 12, 1991 AS DOCUMENT NO. 91-123180, MORE PARTICULARLY DESCRIBED AS FOLLOWS:

BEGINNING AT THE SOUTHEAST CORNER OF SAID WEST HALF OF THE NORTHWEST QUARTER OF THE NORTHWEST QUARTER OF THE SOUTHWEST QUARTER;

THENCE SOUTH 89°43'36" WEST ALONG THE SOUTH LINE OF SAID WEST HALF OF THE NORTHWEST QUARTER OF THE NORTHWEST QUARTER OF THE SOUTHWEST QUARTER, A DISTANCE OF 60.00 FEET;

THENCE NORTH 00°16'24" WEST A DISTANCE OF 124.37 FEET;

THENCE NORTH 50°05'49" EAST A DISTANCE OF 79.37 FEET TO THE EAST LINE OF SAID WEST HALF OF THE NORTHWEST QUARTER OF THE NORTHWEST QUARTER OF THE SOUTHWEST QUARTER;

THENCE SOUTH 00°05'49" WEST ALONG SAID EAST LINE OF THE WEST HALF OF THE NORTHWEST QUARTER OF THE NORTHWEST QUARTER OF THE SOUTHWEST QUARTER, A DISTANCE OF 175.00 FEET TO THE POINT OF BEGINNING.

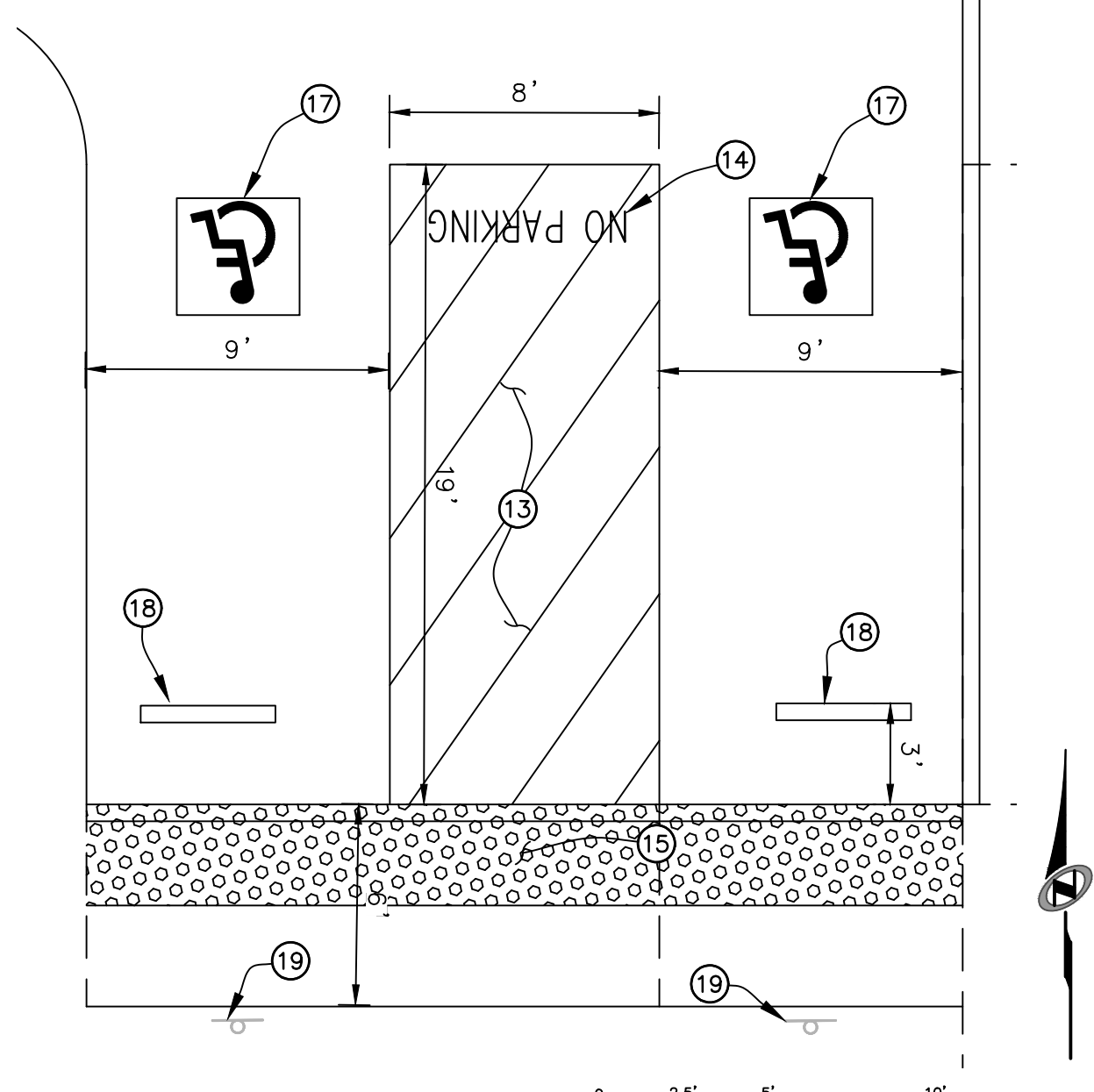

- CONSTRUCTION NOTES**
- 13 STRIPE ACCESSIBLE PATH WITH 3" BLUE PERIMETER STRIPE AND AT 45° ANGLE, 3" O.C.
  - 14 "NO PARKING" 12" HIGH STENCIL MARKING, REFLECTIVE WHITE OVER BLUE STRIPES
  - 15 INSTALL TRUNCATED DOMES PER DETAIL 5, THIS SHEET
  - 16 INSTALL SIGNAGE PER DETAIL 2, THIS SHEET
  - 17 ISA SYMBOL PER DETAIL 3, THIS SHEET
  - 18 INSTALL WHEEL STOP
  - 19 INSTALL SIGNAGE PER DETAIL 2, THIS SHEET

**1 ACCESSIBLE PARKING LAYOUT**

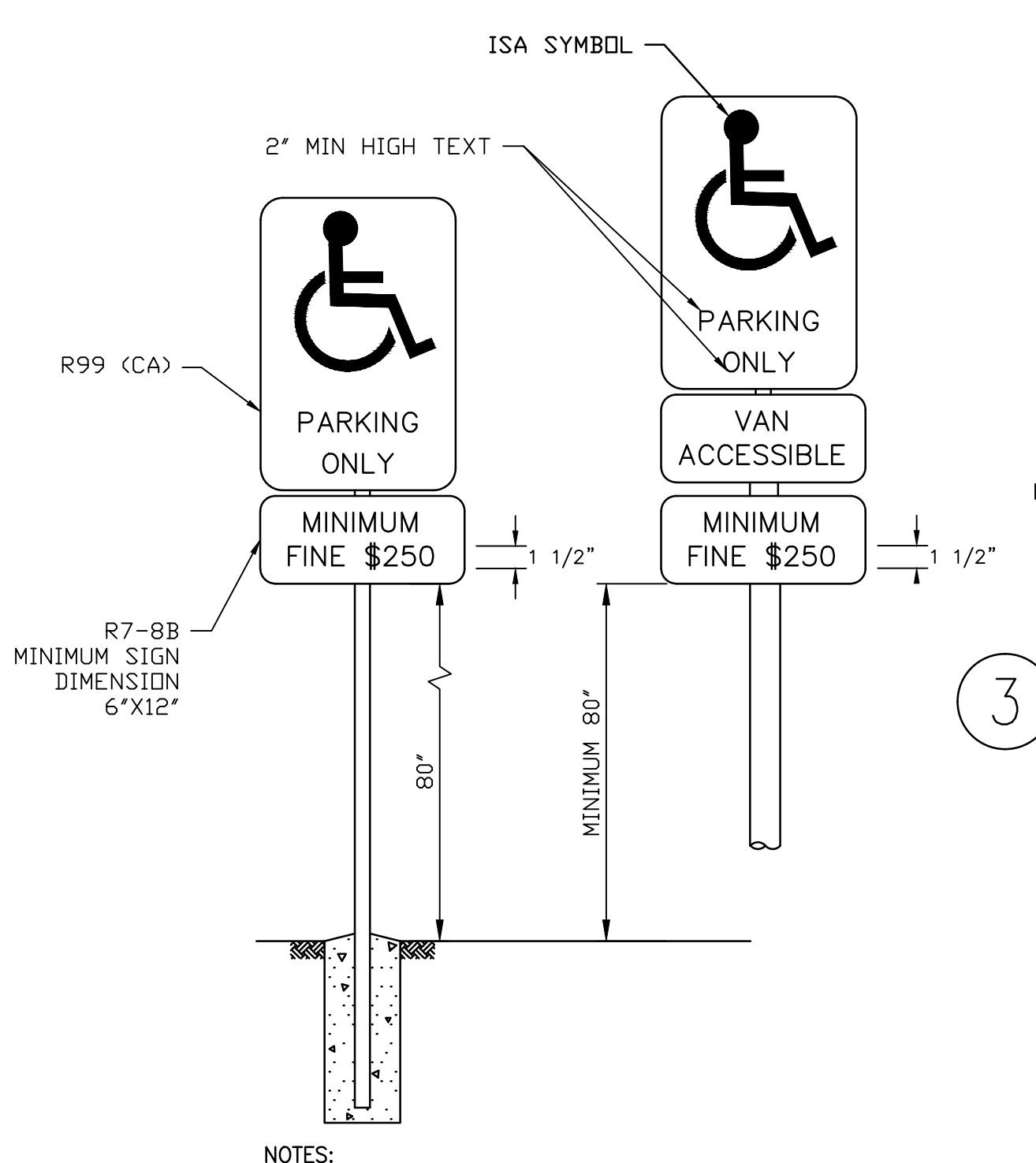

- NOTES:**
1. SIGN SHALL BE CONSTRUCTED OF A MINIMUM 0.062" THICK ALUMINUM.
  2. LETTERING, SYMBOL AND BORDER SHALL BE REFLECTORIZED WHITE, ON A BLUE BACKGROUND.
  3. SYMBOL PROPORTIONS SHALL APPROXIMATE CBC FIGURE 11B-703.7.2.1

**2 ACCESSIBLE PARKING SIGN N.T.S.**

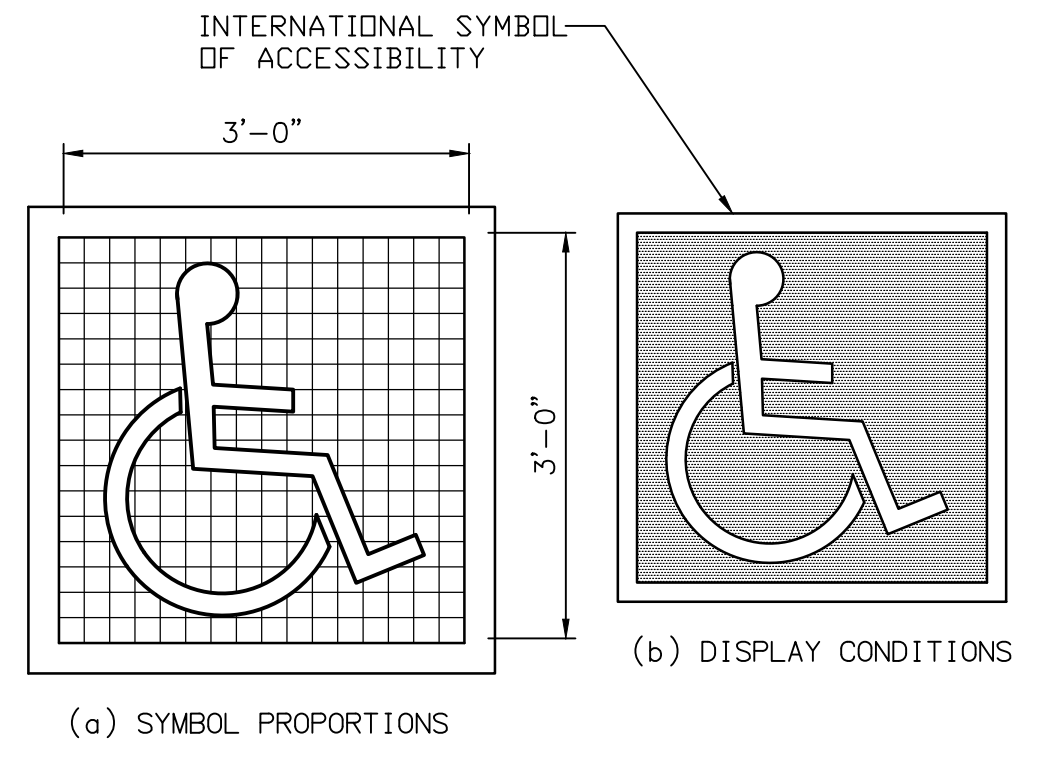

- NOTES:**
1. PAVEMENT SYMBOL SHALL BE PAINTED WHITE ON A BLUE BACKGROUND.
  2. BLUE COLOR SHOULD MATCH COLOR NO. 15090 IN THE FEDERAL STANDARD 595C AS SPECIFIED IN SECTION 522(B)2.
  3. SYMBOL PROPORTIONS SHALL APPROXIMATE CBC FIGURE 11B-703.7.2.1

**3 INTERNATIONAL SYMBOL OF ACCESS (ISA) N.T.S.**

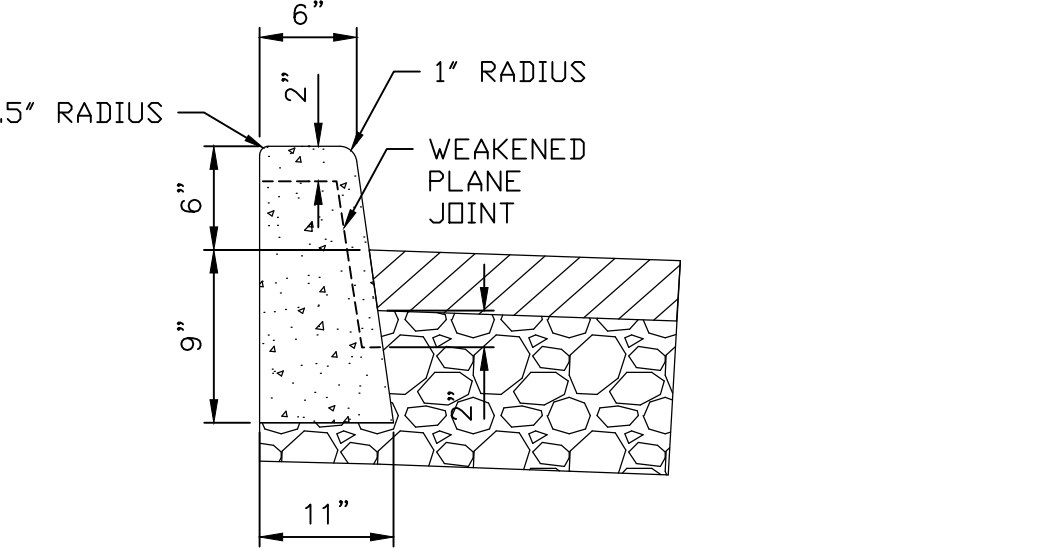

**4 CONCRETE CURB N.T.S.**

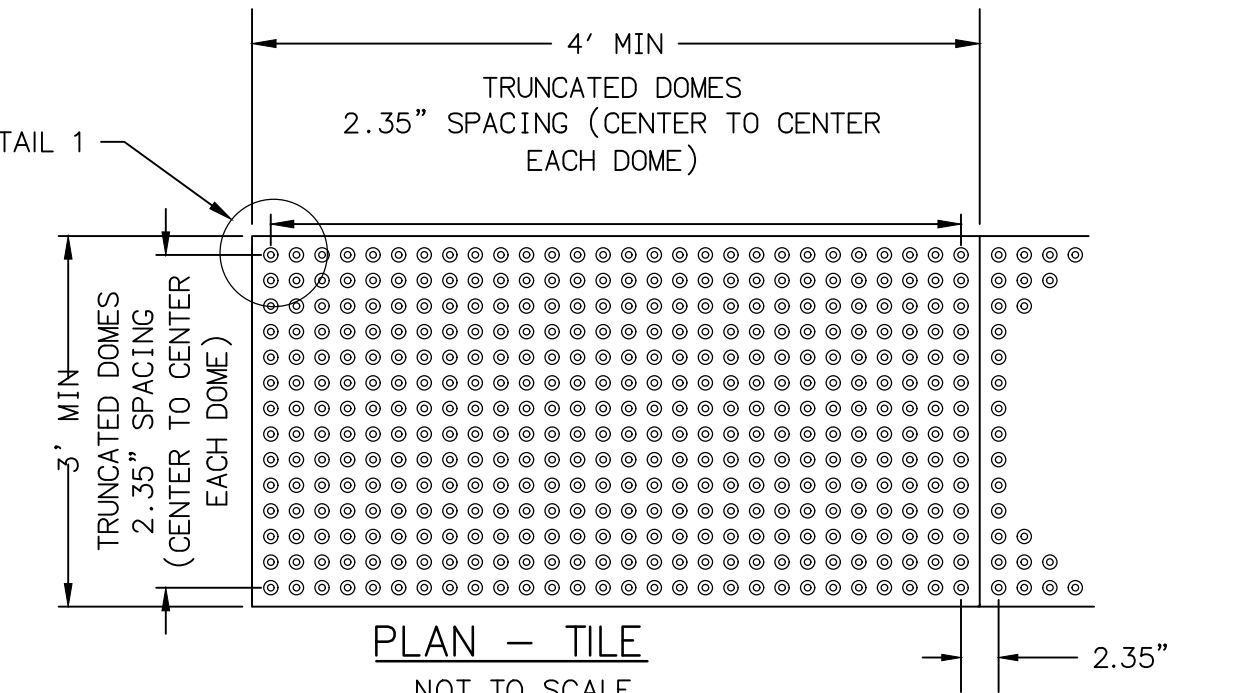

- NOTES:**
1. DETECTABLE WARNING SURFACE COLOR SHALL BE YELLOW CONFORMING TO FEDERAL STANDARDS 595C TABLE IV, COLOR NO. 33538, OR AS SPECIFIED BY THE AGENCY. COLOR SHALL BE HOMOGENEOUS THROUGHOUT THE TILE.
  2. DURING AND AFTER THE TILE INSTALLATION AND THE CONCRETE CURING STAGE, IT IS IMPERATIVE THAT THERE IS NO WALKING, LEANING OR EXTERNAL FORCES PLACED ON THE TILE TO ROCK THE TILE, CAUSING A VOID BETWEEN THE UNDERSIDE OF THE TILE AND CONCRETE.
  3. ADJACENT TILES SHALL MAINTAIN A 2.35" SPACING FROM CENTER OF TRUNCATED DOME TO CENTER OF TRUNCATED DOME. SEE DETAIL 2.

**5 TRUNCATED DOMES N.T.S.**

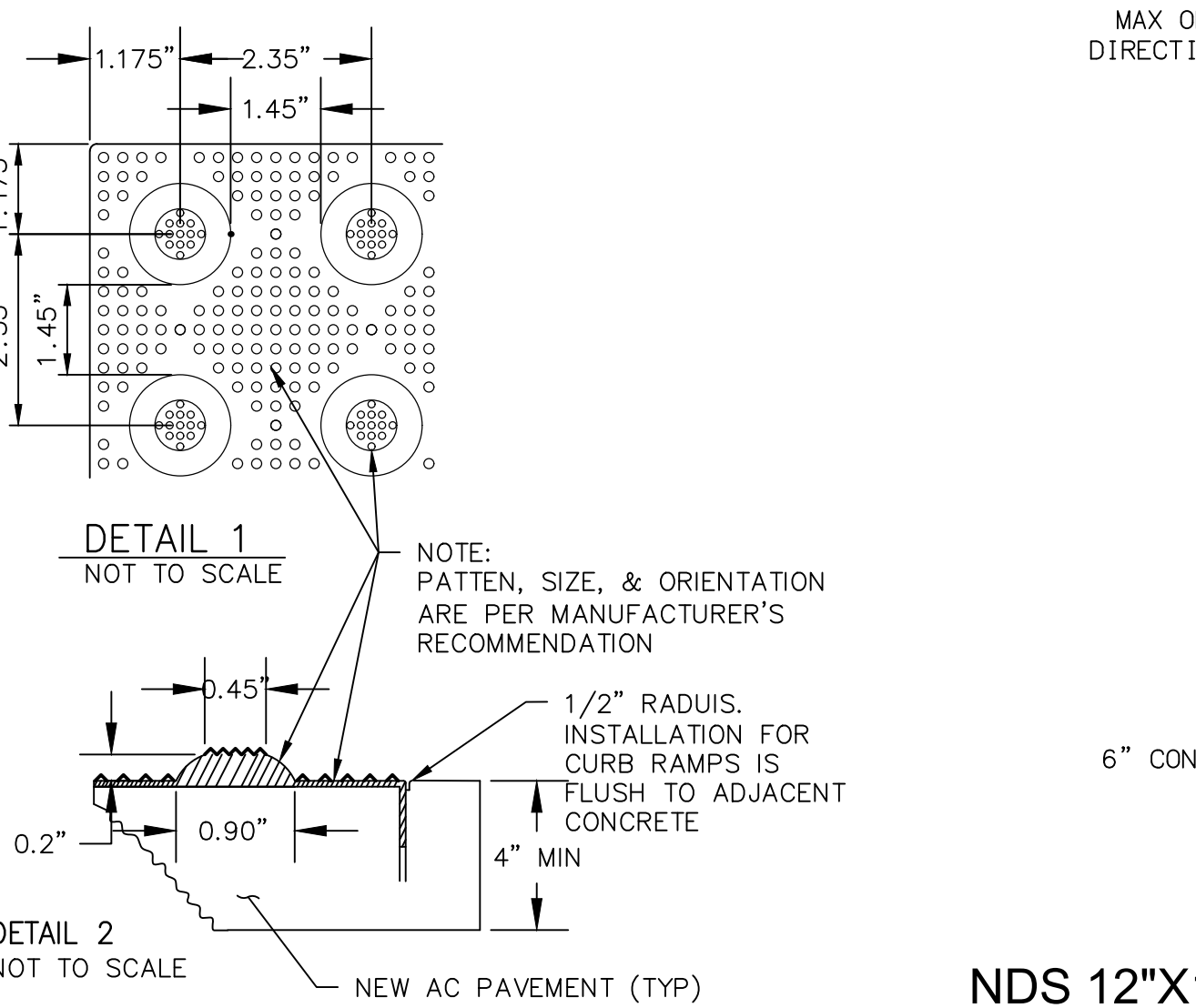

**6 NDS 12"X12" CATCH BASIN WITH SQUARE BASIN GRATE WITH 12" CATCH BASIN FILTER (OR APPROVED EQUAL) N.T.S.**

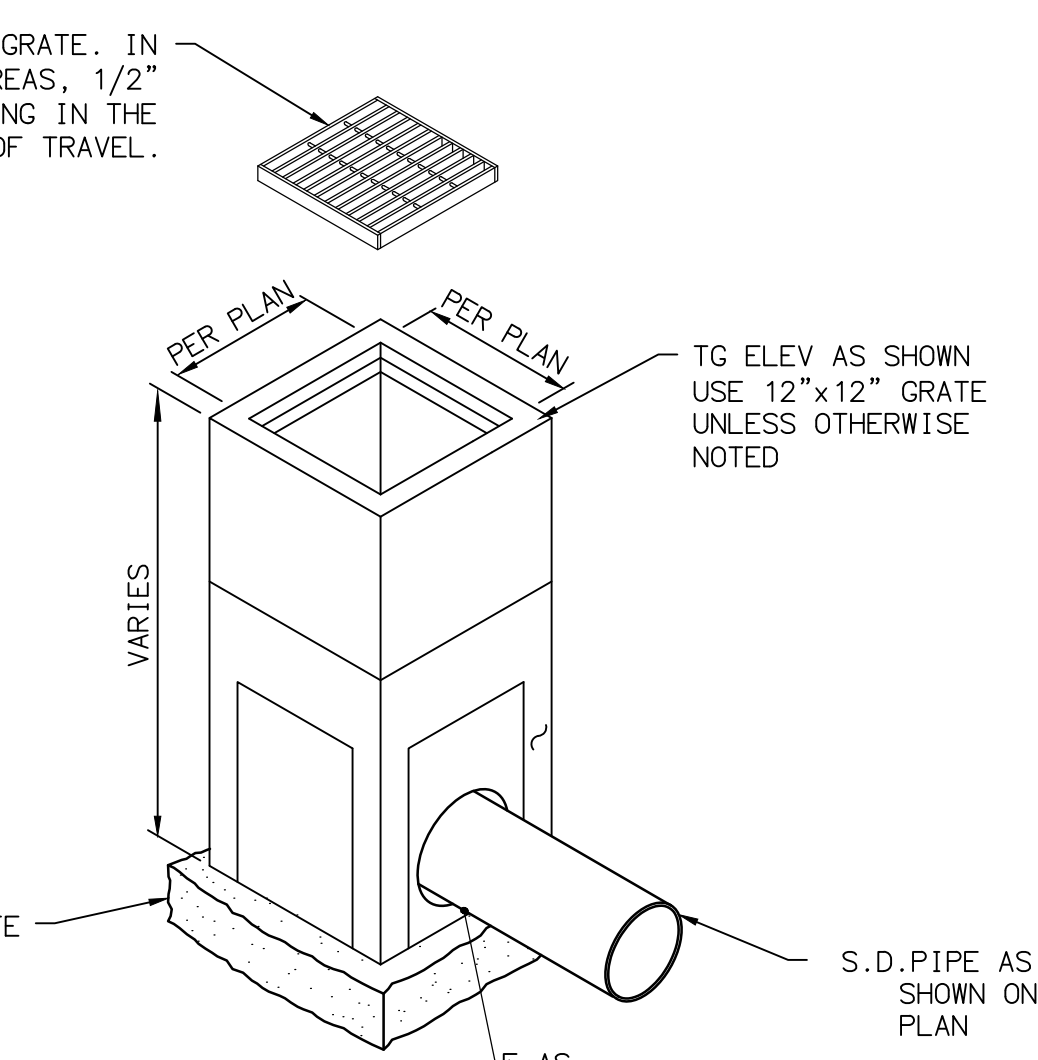

**7 0" TO 6" CONCRETE CURB TRANSITION N.T.S.**

- GRADING PLAN GENERAL NOTES**
1. ALL WORK SHALL BE DONE IN ACCORDANCE WITH THE STANDARD PLANS OF THE TOWN OF YUCCA VALLEY AND STANDARD SPECIFICATIONS FOR PUBLIC WORKS CONSTRUCTION (GREENBOOK), LATEST EDITION, AND THE PROJECT'S CONDITIONS OF APPROVAL.
  2. THE CONTRACTOR SHALL BE RESPONSIBLE FOR PROVIDING AN EFFECTIVE MEANS OF DUST CONTROL WHICH SHALL INCLUDE PROVISIONS FOR ADEQUATE WATERING DURING THE GRADING PROCESS AND PROVISIONS FOR CONTINUANCE OF DUST CONTROL UNTIL THE GRADE SURFACE PRESENTS SUFFICIENT COVER AGAINST WIND OR WATER EROSION THAT SPECIAL DUST CONTROL MEASURES ARE NO LONGER NECESSARY.
  3. CONTRACTOR SHALL OBTAIN ALL PERMITS AS REQUIRED BY THE TOWN OF YUCCA VALLEY DEVELOPMENT CODE.
  4. ALL GRADING SHALL COMPLY WITH APPENDIX CHAPTER 33 OF THE CALIFORNIA BUILDING CODE, LATEST EDITION.
  5. THE LOCATION OF EXISTING UNDERGROUND UTILITIES ARE SHOWN IN AN APPROXIMATE WAY ONLY. SUBJECT TO THE PROVISIONS OF SECTION 4215 OF THE CALIFORNIA GOVERNMENT CODE, THE CONTRACTOR SHALL DETERMINE THE EXACT LOCATION OF ALL EXISTING UTILITIES BEFORE COMMENCING WORK. CONTACT UNDERGROUND SERVICE ALERT (U.S.A.) AT 1-800-227-2600 TWO WORKING DAYS PRIOR TO ANY EXCAVATION.
  6. DIMENSIONING TO CURBS SHALL BE TO FACE OF CURB.
  7. CONTRACTOR SHALL DISPOSE OF ALL DEBRIS OFF-SITE AT A LEGALLY APPROVED DISPOSAL SITE.
  8. CONTRACTOR SHALL REMOVE ALL ABANDONED UTILITY FACILITIES AND SHOW LIMITS OF REMOVALS OF THE RECORD DRAWING.
  9. THE CONTRACTOR SHALL BE RESPONSIBLE FOR THE REMOVAL, REPLACEMENT OR RELOCATION OF ALL REGULATORY, WARNING AND GUIDE SIGNS.
  10. THE ASPHALT DESIGN MUST MEET THE CALTRANS STANDARD SPECIFICATIONS, 2015, SECTION 39, FOR TYPE B ASPHALT, 3/4" MAXIMUM MEDIUM AND 1/2" MAXIMUM MEDIUM. THE OIL SHALL BE P.G. 70-10.
  11. THE AGGREGATE BASE SHALL BE CLASS II, FOR 3/4" MAXIMUM ACCORDING TO THE STATE OF CALIFORNIA STANDARD SPECIFICATIONS, SECTION 26, DATED 2015.
  12. A 'RECORD DRAWING' (FORMERLY CALLED 'AS-BUILT' DRAWING) OF THIS PLAN MUST BE SUBMITTED TO AND APPROVED BY THE TOWN ENGINEER BY THE PROJECT ENGINEER OF RECORD PRIOR TO ACCEPTANCE OF THE PROJECT.
  13. CONSTRUCTION SIGNING, LIGHTING AND BARRICADING SHALL BE PROVIDED ON ALL PROJECTS AS REQUIRED BY TOWN STANDARDS OR AS DIRECTED BY THE TOWN ENGINEER. AS A MINIMUM, ALL CONSTRUCTION SIGNING, LIGHTING AND BARRICADING SHALL BE IN ACCORDANCE WITH STATE OF CALIFORNIA, DEPARTMENT OF TRANSPORTATION, 'MANUAL OF TRAFFIC CONTROLS FOR CONSTRUCTION AND MAINTENANCE WORK ZONES' DATE 1991, OR SUBSEQUENT EDITIONS IN FORCE AT THE TIME OF CONSTRUCTION.
  14. THE FLOW LINES OF ALL CURB AND GUTTERS AND CROSS GUTTERS SHALL BE WATER TESTED BEFORE ACCEPTANCE OF THE PROJECT.
  15. PARKING STALLS SHALL BE CLEARLY DELINEATED WITH A 4 TO 6 INCH STRIPE 'HAIRPIN' OR ELONGATED 'U' DESIGN OR OTHER APPROVED STRIPING OR STALL DELINEATION.
  16. FINAL SITE GRADING AND DRAINAGE FLOW LINES SHALL BE CERTIFIED, IN WRITING, BY THE ENGINEER OF RECORD TO BE IN CONFORMANCE TO THE APPROVED GRADING PLAN PRIOR TO FINAL INSPECTION.
  17. NPDES PERMIT IS REQUIRED PRIOR TO ISSUANCE OF A GRADING PERMIT FOR PARCELS 1 ACRES OR GREATER.
  18. THE LOCATION OF BLOCK WALLS, RETAINING WALLS, AND OTHER STRUCTURES SHALL BE CLEARLY DEFINED ON THE PLANS. CONSTRUCTION AND STRUCTURAL DETAILS SHALL NOT BE SHOWN ON THE GRADING PLAN.
  19. ALL PROVISIONS OF THE PRELIMINARY SOILS REPORT PREPARED BY SLADDEN ENGINEERING DATED MAY 23, 2017 SHALL BE COMPLIED WITH.
  20. THIS PLAN IS FOR GRADING PURPOSES ONLY. APPROVAL DOES NOT CONSTITUTE APPROVAL OF BUILDING LOCATIONS, OFF-SITE DRAINAGE FACILITIES, DRIVEWAY LOCATIONS OR SIZES, PARKING LOT LAYOUT, ETC. OR OTHER ITEMS NOT RELATED TO BASIC GRADING OPERATIONS. NO STRUCTURAL CALCULATIONS HAVE BEEN MADE FOR ANY STRUCTURES ON THIS PLAN DURING PLAN CHECK, THEREFORE, THE PLAN CHECK ENGINEER TAKES NO RESPONSIBILITY FOR THE INTEGRITY OF SUCH STRUCTURES.
  21. UPON ISSUANCE OF GRADING PERMIT BY THE TOWN OF YUCCA VALLEY ALL GRADING SHALL BE UNDERTAKEN AND COMPLETED IN COMPLIANCE WITH TOWN OF YUCCA VALLEY ORDINANCE NO. 133, IN PARTICULAR, SECTION 4, 4. APPENDIX, VOLUME 1, CHAPTER 33, EXCAVATION AND GRADING, A. SECTION 3309.3 GRADING DESIGNATION, B. SECTION 3316, EROSION CONTROL AND S. SECTION 3320 ENGINEERING REPORTS AND THE PROJECT ENGINEER OF RECORD SHALL CERTIFY THAT ALL GRADING COMPLIES WITH SAID ORDINANCE PRIOR TO ACCEPTANCE OF ISSUANCE OF ANY PERMITS BY THE TOWN OF YUCCA VALLEY.
  22. THESE PLANS SHALL EXPIRE IF CONSTRUCTION HAS NOT STARTED WITHIN TWELVE (12) MONTHS FROM THE DATE OF APPROVAL BY THE TOWN.

**REVISIONS**

| MARK | DATE | INITIAL | DESCRIPTION | DATE | APP'VD |
|------|------|---------|-------------|------|--------|
|      |      |         |             |      |        |
|      |      |         |             |      |        |
|      |      |         |             |      |        |
|      |      |         |             |      |        |
|      |      |         |             |      |        |

THIS PLAN PREPARED BY

**NV5**

42-829 COOK STREET, SUITE 104, PALM DESERT, CA 92211 (714) 760.341.3101 TEL 760.341.5999 FAX WWW.NV5.COM

PREPARED UNDER THE SUPERVISION OF:

- R.C.E. No. XXXXX, EXP. X/XX/XX - DATE



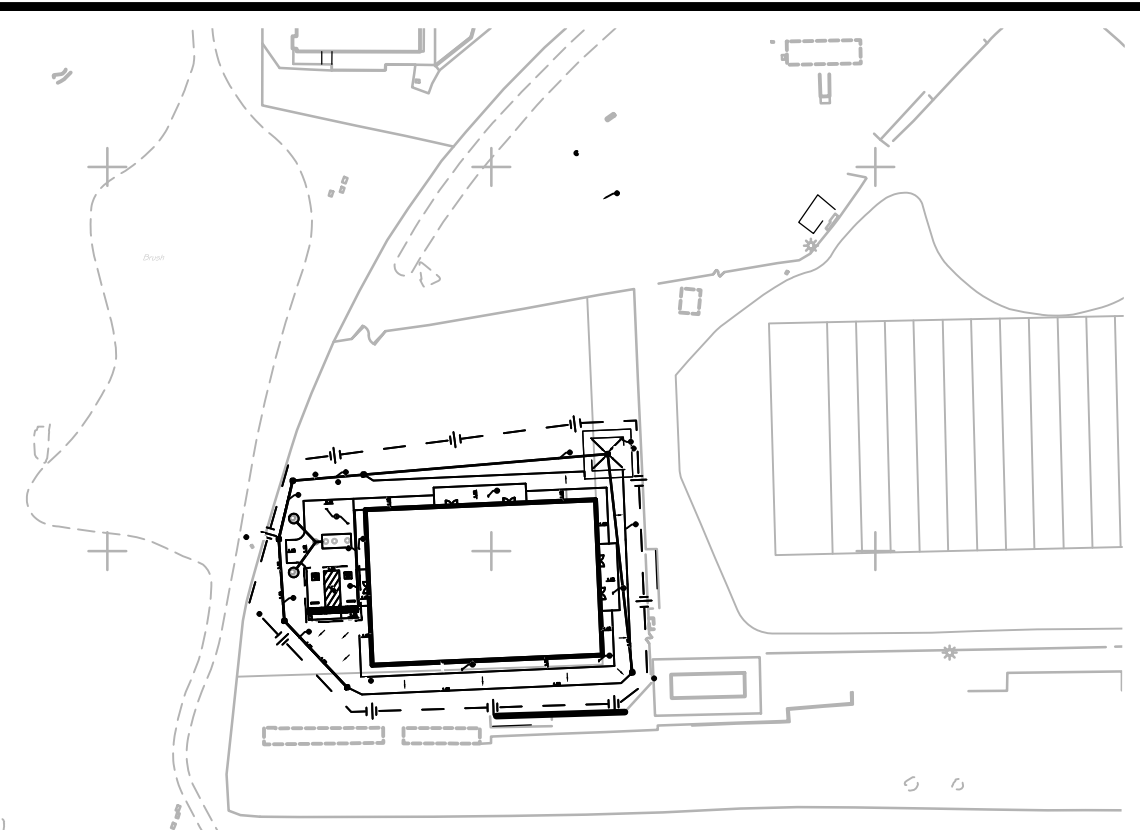

LOT LAYOUT  
SCALE: 1"=100'

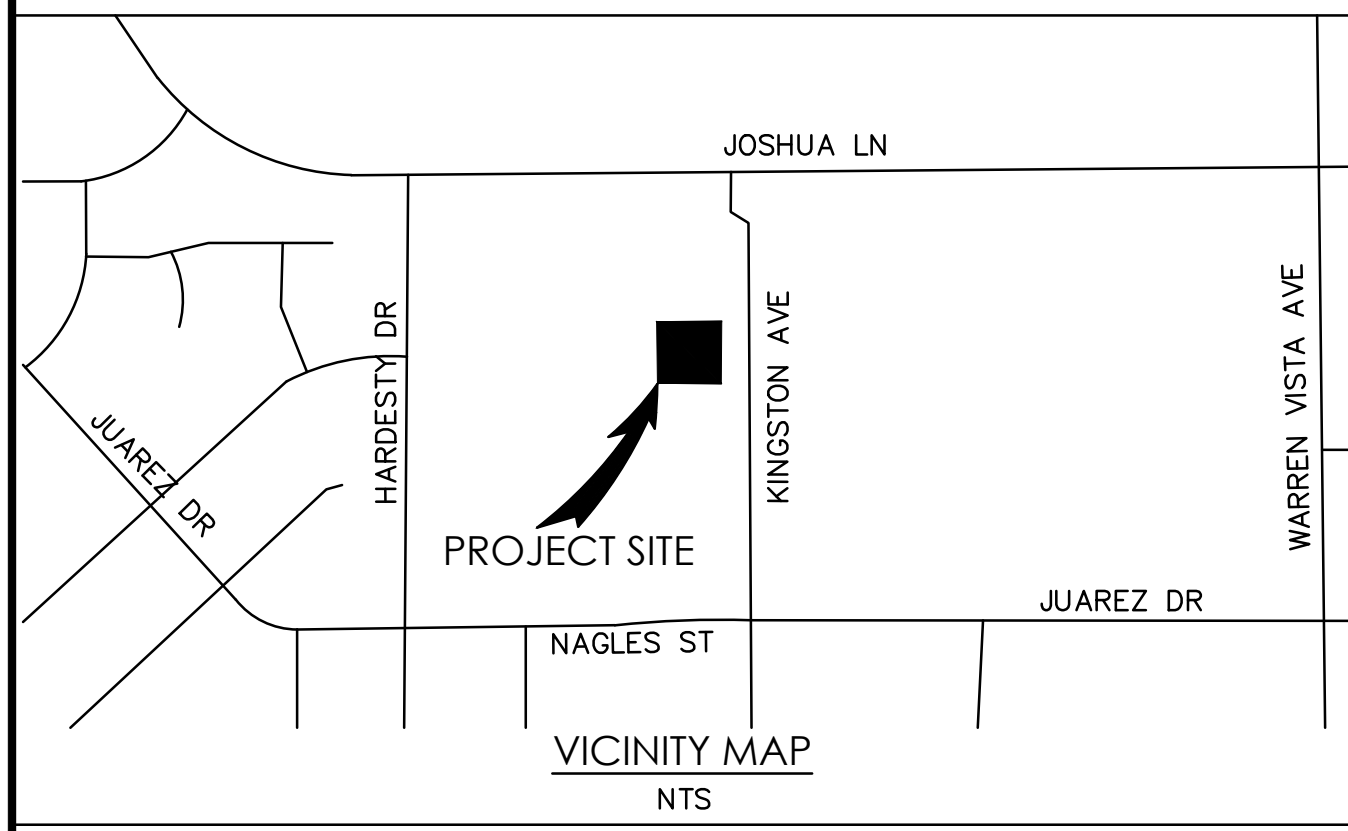

VICINITY MAP  
NTS

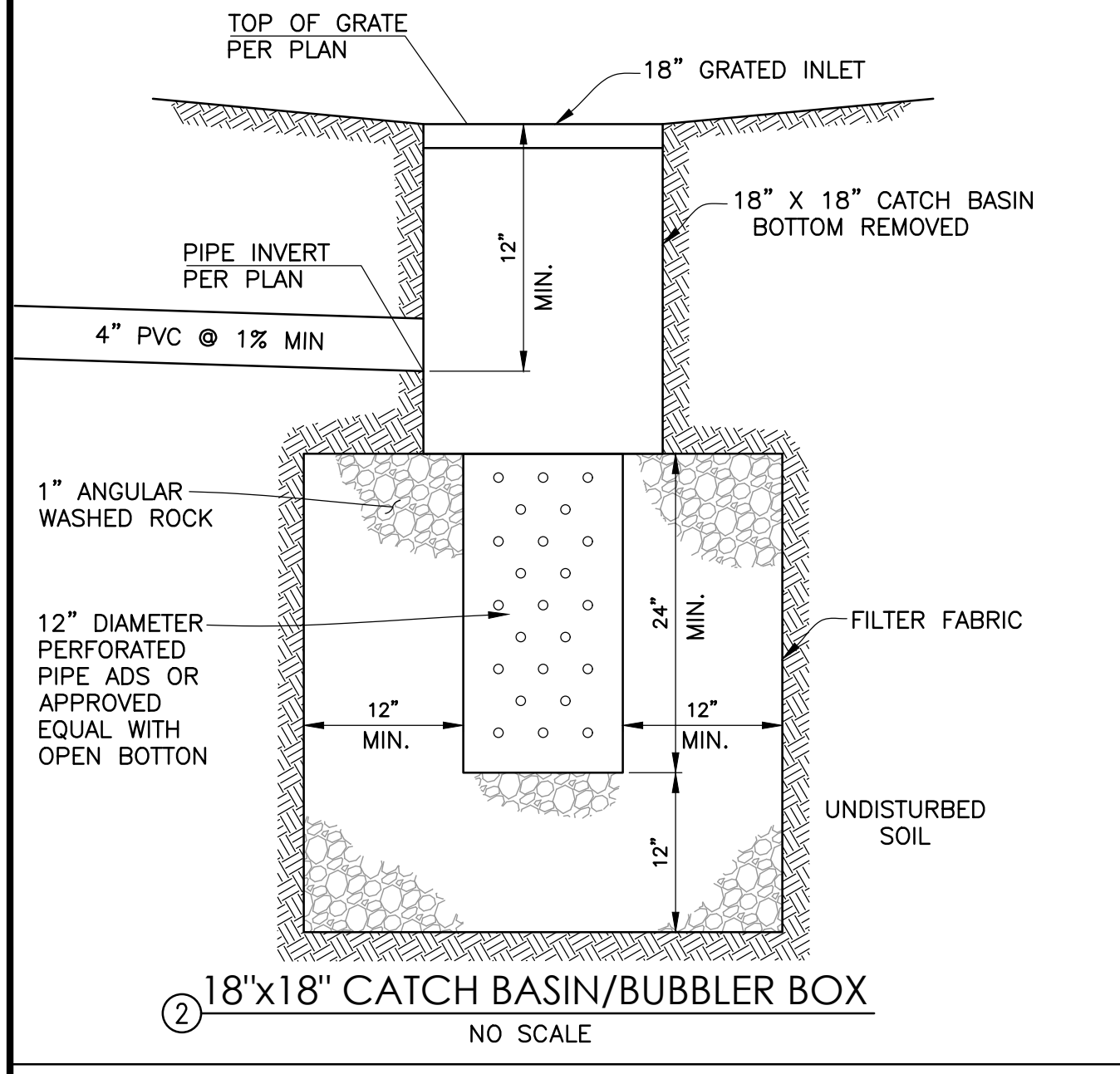

② 18'x18' CATCH BASIN/BUBBLER BOX  
NO SCALE

CONSTRUCTION NOTES

- ① CONSTRUCT 6" THICK VEHICULAR CONCRETE
- ② CONSTRUCT 4" CONCRETE SIDEWALK. SUBGRADE SHALL BE COMPACTED TO A MINIMUM OF 90% RELATIVE COMPACTION.
- ③ CONSTRUCT NEW 6" CURB PER DETAIL 4, SHEET 1
- ④ CONNECTION TO BUBBLER BOX PER DETAIL 1, SHEET 2
- ⑤ INSTALL 6" SCHEDULE 40 PVC DRAIN PIPE WITH FITTINGS
- ⑥ PROPOSED FDC/PIV
- ⑦ PROPOSED FIRE HYDRANT
- ⑧ INSTALL CATCH BASIN PER DETAIL 6, SHEET 1
- ⑨ INSTALL 12" SCHEDULE 40 PVC DRAIN PIPE WITH FITTINGS
- ⑩ CONSTRUCT 0"-6" CURB TRANSITION PER DETAIL 7, SHEET 1

**DIG ALL RT**  
CALL AT LEAST TWO WORKING DAYS PRIOR TO EXCAVATING  
1-800-422-4133  
UNDERGROUND SERVICE ALERT OF SOUTHERN CALIFORNIA  
BEFORE EXCAVATING, THE CONTRACTOR SHALL VERIFY THE LOCATION OF UNDERGROUND UTILITIES BY CONTACTING UTILITY UNDERGROUND SERVICE ALERT AT 1-800-422-4133

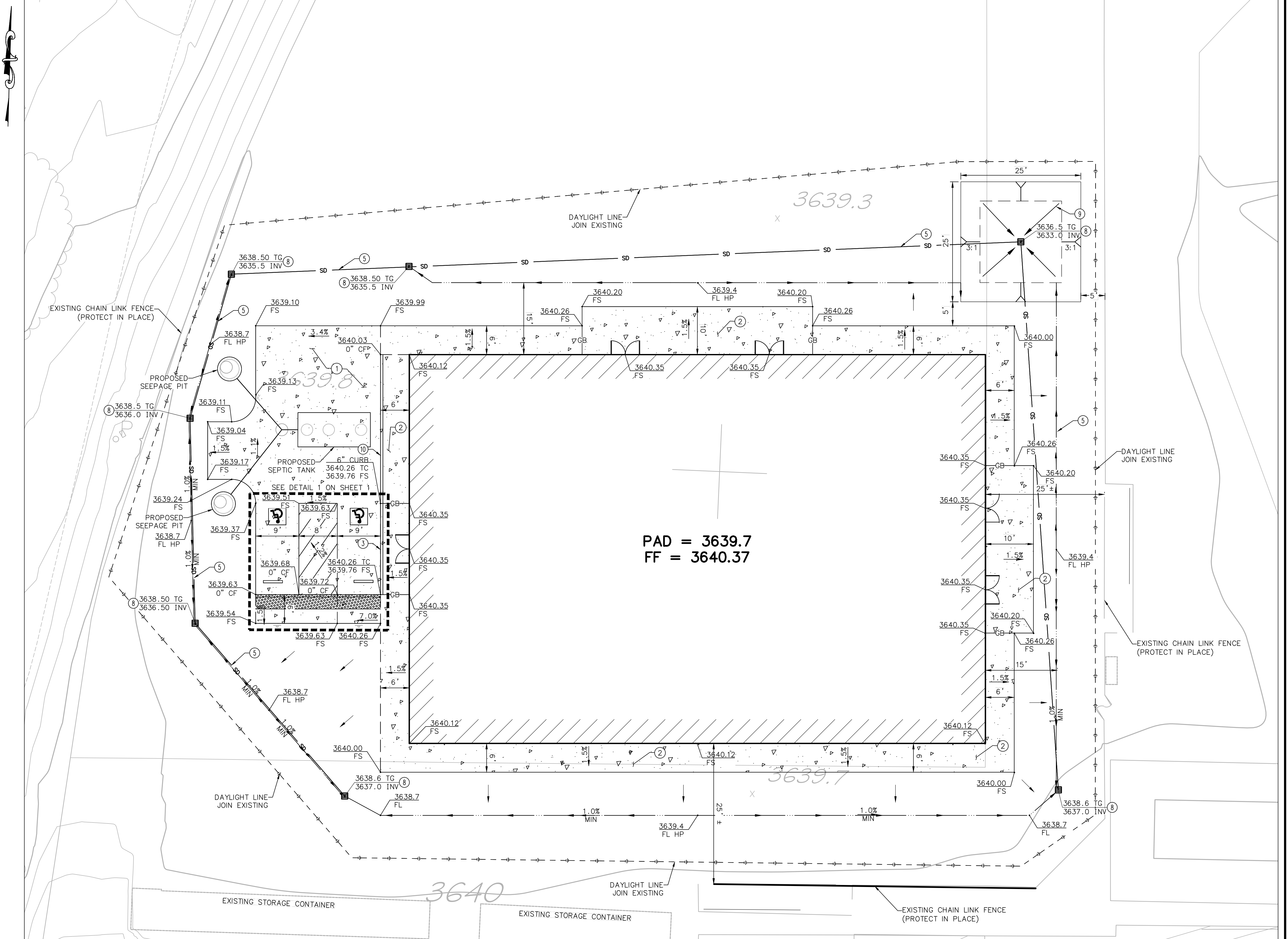
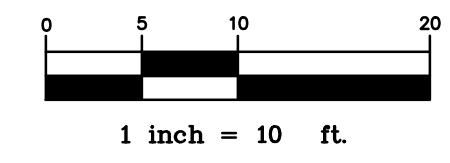

PAD = 3639.7  
FF = 3640.37

| REVISIONS |      |         |             |      |
|-----------|------|---------|-------------|------|
| MARK      | DATE | INITIAL | DESCRIPTION | DATE |
|           |      |         |             |      |
|           |      |         |             |      |
|           |      |         |             |      |
|           |      |         |             |      |

THIS PLAN PREPARED BY  
**NIV5**  
42-829 COOK STREET, SUITE 104, PALM DESERT, CA 92211 (714)  
760.341.3101 TEL 760.341.5999 FAX WWW.NIV5.COM  
PREPARED UNDER THE SUPERVISION OF:  
- R.C.E. No. XXXXX, EXP. X/XX/XX - DATE



**TOWN OF YUCCA VALLEY**  
JOSHUA SPRINGS CALVARY CHAPEL  
GRADING PLAN

SHEET  
**2**  
OF 3 SHEETS  
DRAWING NO.  
PDB030600

# IN THE TOWN OF YUCCA VALLEY, COUNTY OF SAN BERNARDINO FUGITIVE DUST AND EROSION- CONTROL PLAN FOR APN 0585-062-65

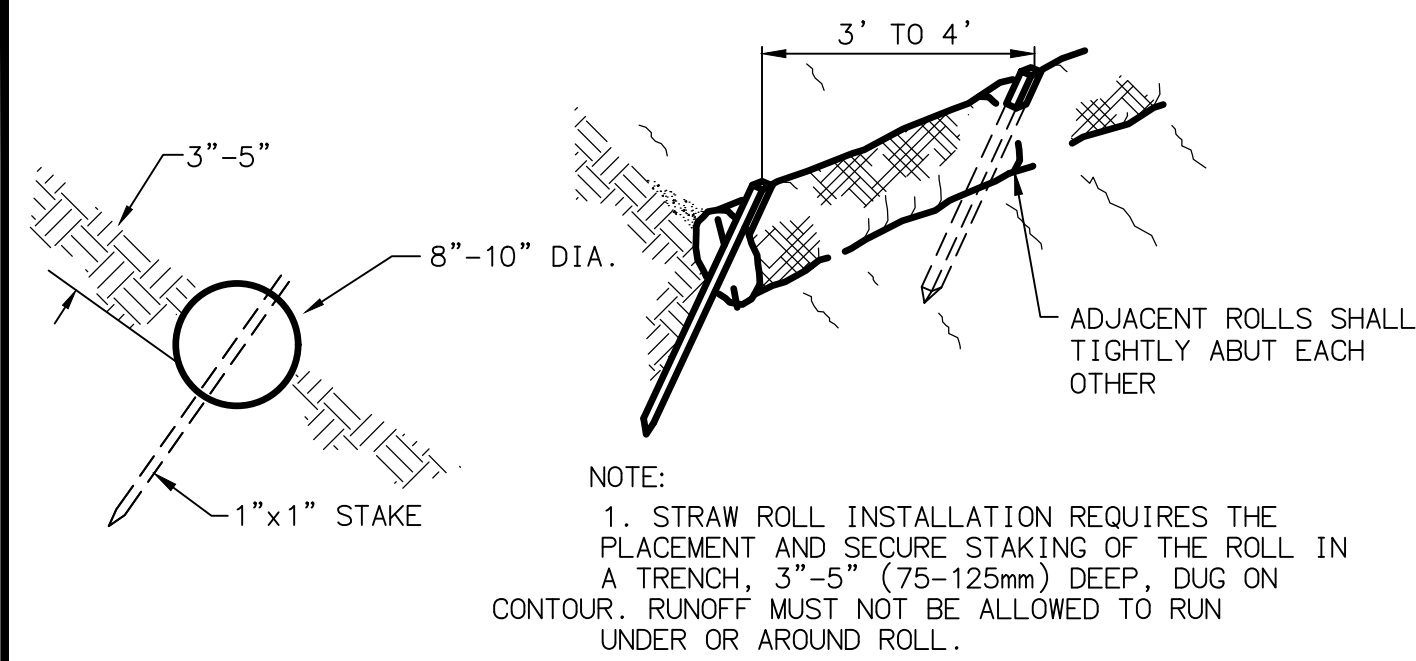

**A FIBER ROLL DETAIL**  
N.T.S.

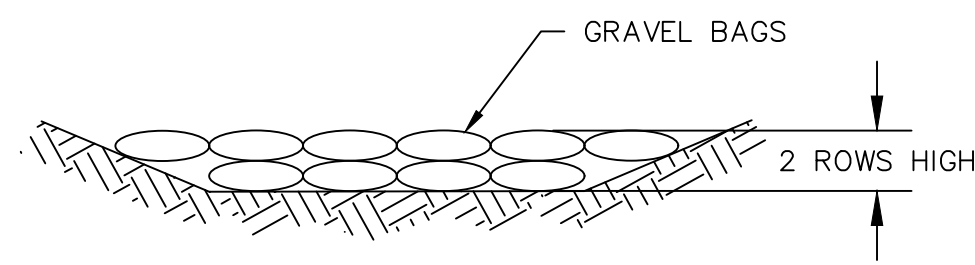

**B GRAVEL BAGS**  
N.T.S.

### EROSION/DUST CONTROL NOTES

- NO LAND CLEARING OR GRADING SHALL BEGIN UNTIL ALL PERMITS HAVE BEEN ISSUED.
- ALL EXPOSED AREAS SHALL BE STABILIZED AS SPECIFIED WITHIN 30 DAYS OF FINAL GRADING.
- SHOULD CONSTRUCTION STOP FOR LONGER THAN 15 DAYS THE SITE SHALL BE STABILIZED AS SPECIFIED.
- CONTRACTOR SHALL MAINTAIN EROSION CONTROL MEASURES DURING AND AFTER EACH RAIN AND AT LEAST ONCE A WEEK.
- THIS PLAN SHALL NOT BE CONSIDERED ALL INCLUSIVE AS THE CONTRACTOR SHALL TAKE ALL NECESSARY PRECAUTIONS TO PREVENT SOIL SEDIMENT AND POLLUTANTS FROM LEAVING THE SITE.
- CONTRACTOR SHALL COMPLY WITH ALL STATE AND LOCAL ORDINANCES THAT APPLY.
- ADDITIONAL EROSION AND SEDIMENT CONTROL MEASURES SHALL BE INSTALLED IF DEEMED NECESSARY BY ON-SITE INSPECTION.
- CONTRACTOR SHALL BE RESPONSIBLE TO TAKE WHATEVER MEANS NECESSARY TO ESTABLISH PERMANENT SOIL STABILIZATION PER CITY REQUIREMENTS.
- IF, IN THE OPINION OF THE CITY ENGINEER OR HIS DESIGNEE, THE INTENSITY, FREQUENCY OR DURATION OF FUGITIVE DUST EMISSIONS FROM THE SITE CONSTITUTES A HAZARD TO THE SAFETY OF THE PUBLIC, BY INTRUSION BEYOND THE PROJECT BOUNDARY, THE CITY ENGINEER OR HIS DESIGNEE OR AGENT MAY IMMEDIATELY ENTER UPON THE SITE OR IMMEDIATELY TAKE OTHER SUCH ACTION AS MAY BE NECESSARY TO REMEDY THE HAZARD, SUCH AS, BUT NOT LIMITED TO COMMENCING WATERING ON THE SITE OR ORDERING THE CESSATION OF ANY EMISSION-GENERATING ACTIVITY OCCURRING ON-SITE.

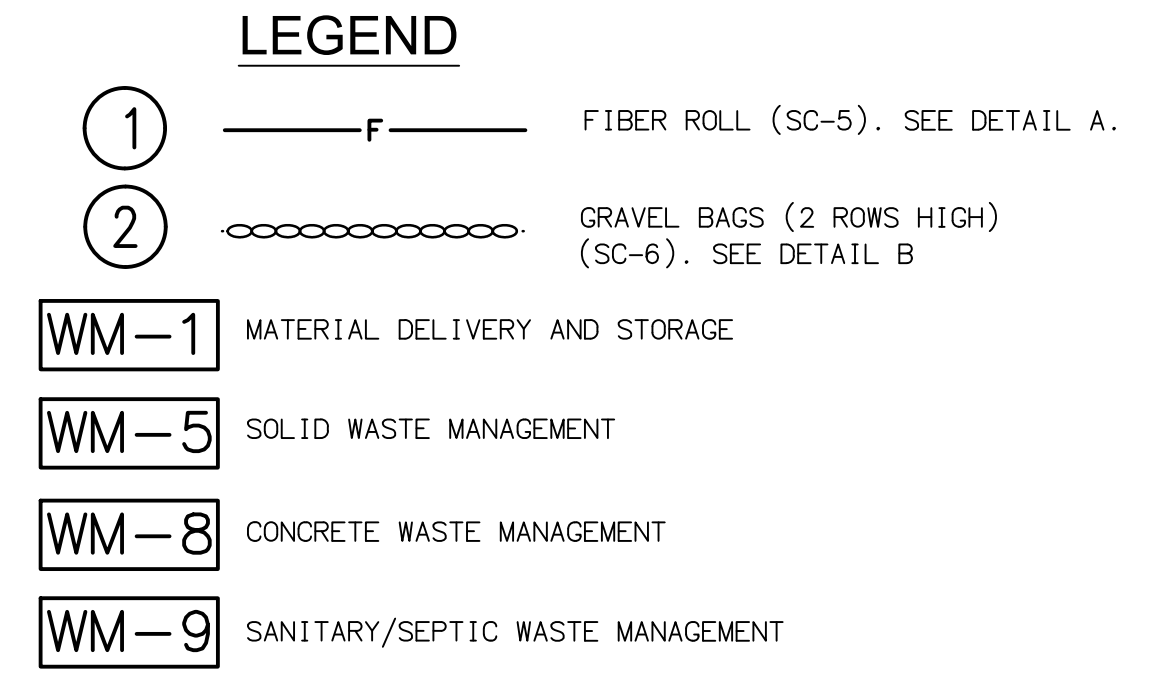
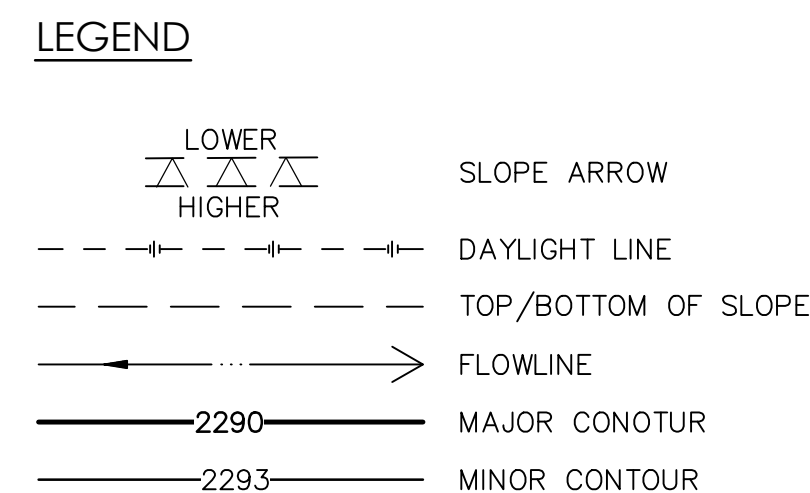
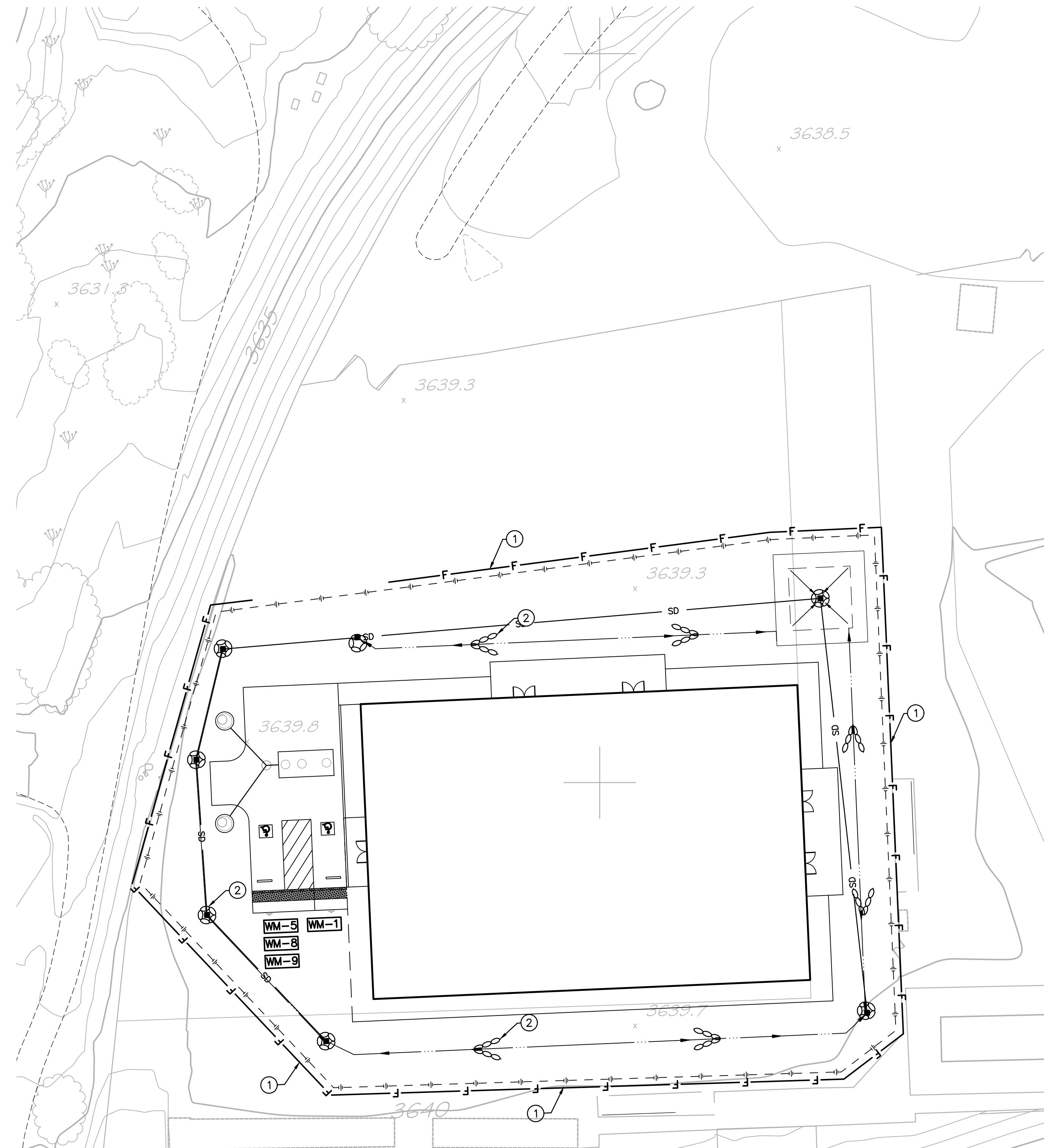

### PHASING OF GRADING ACTIVITIES

THE AMOUNT OF ACTIVE DISTURBED AREA MUST BE LIMITED TO WHAT CAN BE EFFECTIVELY WATERED 4 TIMES PER DAY BY EITHER SPRINKLERS OR WATER TRUCKS. TYPICAL 2000 GALLON WATER TRUCKS CAN EFFECTIVELY WATER ABOUT 4 ACRES PER HOUR, THEREFORE AN 8 HR. WORKDAY DIVIDED BY 4 WATERING'S PER DAY TIMES 4 AC./HR. = 8 ACRES PER TRUCK. SINCE WATER TRUCKS ARE ALLOWED TO WORK 7 DAYS A WEEK, 24 HOURS A DAY, IN SOME LOCATIONS, UP TO 24 ACRES PER TRUCK MAY BE ACHIEVED THAT WAY, WITH SPECIAL PERMISSION. LARGER PROJECTS MUST HAVE MORE TRUCKS, MORE HOURS, MORE SPRINKLERS, OR LESS DISTURBED AREA AT ANY ONE TIME. AREAS ALREADY GRADED OR STOCKPILED MUST BE STABILIZED WITH CHEMICALS, HYDROMULCH, OR VEGETATION, BEFORE ADDITIONAL AREAS CAN BE STRIPPED FOR GRADING.

### PHASE "A": ROUGH GRADING (SITE PREP. & MOBILIZATION)

- PRE-WATERING SHALL COMMENCE AT LEAST THREE (3) DAYS PRIOR TO ACTUAL GRADING USING A WATER TRUCK. CONNECTION TO ANY EXISTING WATER SYSTEM SHALL BE DONE IN COMPLIANCE WITH TWENTYNINE PALMS WATER DISTRICT. TEMPORARY WATER LINES SHALL BE INSTALLED WITH A MINIMAL DISTURBANCE OF ANY OFF-SITE AREAS THEY PASS THROUGH.
- ACTIVITY AREAS SUCH AS: EQUIPMENT STORAGE AREA, MATERIALS STORAGE AREA, TEMPORARY OFFICE TRAILERS, AND EMPLOYEE PARKING, SHOULD BE LOCATED IF POSSIBLE ON EXISTING PAVED SURFACES. IF TRAFFIC WOULD NOT BE AFFECTED, IN LIEU OF EXISTING PAVING, A SOIL STABILIZER THAT DOES NOT REQUIRE CONSTANT WATERING, SUCH AS A WASHED GRAVEL, OR "BIODEGRADABLE OIL" COULD BE USED FOR THE INITIAL STAGING AREA. ANY CHEMICALS USED MUST BE CLEARED WITH THE CITY AND REGIONAL WATER QUALITY CONTROL BOARD.
- WHEN WIND SPEEDS EXCEED 25 MPH, BY CONTINUOUS ANEMOMETER READING, OR IN GUSTS AT LEAST TWICE WITHIN A THIRTY MINUTE PERIOD, MEASURED ON THE SITE, VEHICULAR ACTIVITY ON THE SITE SHALL CEASE, EITHER VOLUNTARILY, OR BY CITY OR INSPECTOR NOTIFICATION, EXCEPT FOR WATER TRUCKS AND SPRINKLER-TENDING VEHICLES, IF ANY.

### PHASE "B": ROUGH GRADING (ROUGH)

- GENERAL REQUIREMENTS**
- HAULING PROCEDURES: ALL VEHICLES GOING FROM DIRT AREAS ONTO PAVED STREETS SHALL HAVE TIRES AND WHEELS INSPECTED AND WASHED IF NECESSARY TO AVOID "TRACKING-OUT" DIRT. TRUCKS HAULING DIRT ON PAVED STREETS SHALL MAINTAIN AT LEAST A HALF FOOT "FREEBOARD" FROM RIM TO DIRT, AND COVER ALL DIRT OR DUSTY DEBRIS LOADS WITH AN APPROPRIATE TARP. THE HAUL ROUTE SHOULD BE SHOWN HERON OR ON AN ATTACHED SHEET, AND SHALL BE CLEARED WITH THE CITY ENGINEER FOR ANY APPLICABLE TRANSPORT PERMITS PRIOR TO ITS USE. ALL HAULING TRUCKS SHALL HAVE A COPY OF THESE PROVISIONS WITH THEM AT ALL TIMES. THE IMPORT OR EXPORT SITE MUST HAVE A VALID GRADING PERMIT ALSO, AND SHOULD BE COMPLYING WITH ALL APPROPRIATE DUST MITIGATION MEASURES ALSO. WHEN PRACTICAL, TRUCKS AND EQUIPMENT, SHOULD SHUT OFF ENGINES RATHER THAN IDLING FOR EXTENDED PERIODS, TO MINIMIZE EXHAUST EMISSIONS AND NOISE. THIS BECOMES MORE CRITICAL AS THE SIZE AND NUMBERS OF VEHICLES INCREASES.
  - ALL STRIPPED, GRADED OR OTHERWISE DISTURBED AREAS SHALL BE STABILIZED BY SOME APPROPRIATE MEANS. AREAS ACTIVELY BEING GRADED CAN USUALLY BE STABILIZED BY APPLYING WATER OR CHEMICAL SOIL BINDER. DISTURBED AREAS NOT ACTIVELY BEING WORKED MAY BE EFFECTIVELY TREATED WITH SOME MORE DURABLE SOIL STABILIZER, SUCH AS HYDROMULCH, TO AVOID CONSTANT WATERING. THE PREFERRED METHOD OF SITE WATERING IS BY SPRINKLER, ESPECIALLY AROUND THE PERIMETER. SPRINKLERS MUST BE SET TO RUN ON WEEKENDS AND EVENINGS WHEN WATER TRUCK DRIVERS ARE NOT AVAILABLE. A TYPICAL WATER TRUCK CAN ONLY HANDLE WELL ABOUT 4 ACRES PER HOUR.
  - IF PERIMETER BLOCK WALLS ARE TO BE BUILT THEY SHOULD BE GIVEN A HIGH PRIORITY SINCE THEY WILL HELP TO CATCH BLOWSAND AND COULD THEREBY REDUCE THE AMOUNT OF STREET SWEEPING REQUIRED.

### PHASE "C": FINISH GRADING (UTILITY & STREET CONST.)

- GENERAL REQUIREMENTS**
- DIRT STOCKPILED NEXT TO UTILITY TRENCHES SHALL BE KEPT WATERED OR OTHERWISE STABILIZED OR COVERED TO HELP COUNTERACT THEIR HIGH PROFILE EXPOSURE TO THE WIND.

### PHASE "D": FINISH GRADING (BLDG. UTIL., BLDG. CONST., LANDSCAPING)

- GENERAL REQUIREMENTS**
- ALL INACTIVE AREAS SHOULD HAVE BEEN STABILIZED BY THIS STAGE. IF PREVIOUSLY COVERED, THE ACTUAL BUILDING PADS MAY NOW NEED TO BE STRIPPED, SCARIFIED AND RECOMPACTED FOR BUILDING PAD COMPACTION AND ELEVATION CERTIFICATIONS. DUST SHOULD BE MITIGATED BY WATERING, USUALLY BY TEMPORARY SPRINKLERS OR WATER TRUCK.
  - TRENCHING FOR BUILDING FOOTINGS, UTILITIES, DRYWELL CONSTRUCTION, POOLS, AND TENNIS COURT CONSTRUCTION FORM THE BULK OF EARTHWORK AFTER THE PADS HAVE BEEN CERTIFIED. TEMPORARY SPRINKLERS OR WATER TRUCK MAY STILL BE USED ON THE BUILDING SITE FOR DUST CONTROL PRIOR TO THE BEGINNING OF FRAMING. TREATMENT WITH A BIODEGRADABLE "OIL" APPROVED FOR DUST CONTROL IS RECOMMENDED WHERE IT IS DIFFICULT TO WATER.
  - ESTABLISHING THE LANDSCAPE AND SPRINKLER SYSTEM AROUND THE PERIMETER OF LARGE PROJECTS SHOULD BE DONE AT THIS STAGE OR AS SCHEDULED AND WITH RECEIPT OF APPROVED PLANS. PLANTINGS AROUND PERIMETER SERVE AS A WIND BUFFER AND COLLECTION SYSTEM FOR DUST AND SAND. IT IS GOOD TO HAVE DUST AND SAND WELL UNDER CONTROL PRIOR TO THE BUILDING PHASE.
  - DISTURBED AREAS AROUND BUILDINGS SHOULD BE WATERED BY HAND FOR DUST CONTROL UNTIL SUCH TIME THAT THE SPRINKLER SYSTEM IS FULLY FUNCTIONAL AND GRIND COVER AND/OR LANDSCAPING IS ESTABLISHED. IF WATERING IS DIFFICULT DUE TO BUILDING INTERFERENCE, CHEMICAL OR MULCH TREATMENTS ARE AVAILABLE THAT CAN STABILIZE THE SOIL WITHOUT FREQUENT WATERING.
  - CONSTRUCTION DUST SUCH AS FROM CEMENT, PLASTER, PAINT OVERSPRAY, WOOD CUTTING, GRINDING OPERATIONS, ETC., SHOULD BE MINIMIZED ALSO. A PERIMETER BARRIER OF SPRINKLERS, PLANTINGS AND SCREENED FENCING CAN SERVE TO CATCH SOME OF THE POTENTIALLY HAZARDOUS MATERIAL AS WELL AS NATURAL DUST AND BLOWSAND. CONCENTRATIONS OF CONSTRUCTION DUSTS CAN RESULT FROM WASHING OF EQUIPMENT AND SHOULD BE PROPERLY DISPOSED OF BEFORE THEY CAN DRY OUT AND BLOW OR BE WASHED ACROSS PROJECT BOUNDARIES.

| REVISIONS |      |         |             |      |        |
|-----------|------|---------|-------------|------|--------|
| MARK      | DATE | INITIAL | DESCRIPTION | DATE | APP'VD |
|           |      |         |             |      |        |
|           |      |         |             |      |        |
|           |      |         |             |      |        |
|           |      |         |             |      |        |

THIS PLAN PREPARED BY  
**NIV5**  
 42-829 COOK STREET, SUITE 104, PALM DESERT, CA 92211 (714)  
 760.341.3101 TEL 760.341.5999 FAX WWW.NIV5.COM  
 PREPARED UNDER THE SUPERVISION OF:  
 - R.C.E. No. XXXXX, EXP. X/XX/XX - DATE

