

NATIVE PLANT PLAN NOTES

ALL EXISTING PLANTINGS TO REMAIN. PLEASE REFER TO BIOLOGICAL REPORT FOR A MORE DETAILED DISCUSSION OF THE VARIOUS PLANT SPECIES OBSERVED DURING THE SURVEYS.

ADDITIONAL RESTORATIVE PLANTING MAY BE ADDED WITHIN THE JOSHUA TREE CLEAR SPACE RADII, PENDING CDFW CONFIRMATION.

OFFICIAL USE ONLY

PROJECT SCOPE

A CONDITIONAL USE PERMIT (CUP) TO ALLOW NON-RELIGIOUS ASSEMBLY RELATED TO EVENTS HOSTED THE EXISTING FACILITY AND GROUNDS AT APNS 058802121, 058802128, 058802129

LEGAL DESCRIPTION

SITE ADDRESS: 57889 PUEBLO TRAIL, YUCCA VALLEY, CA 92284

LAND USE DISTRICT: RURAL RESIDENTIAL (RR-0.5) 0.5 AC MIN
ZONING DISTRICT: R-S-2

APN: 058802121, 058802128, 058802129, 058801601 (RESTORATION PLANTING ONLY)

APPLICANT: HIGH DESERT CENTER, LLC, 5925 N. MINA VISTA AVE TUCSON, AZ 85718, (760) 646-0642

PREPARATION DATE: 06/25/2025

(E) TO REMAIN NATIVE PLANT LEGEND

- YUCCA BREVIFOLIA / WESTERN JOSHUA TREE
- YUCCA BREVIFOLIA / WESTERN JOSHUA TREE (DEAD)
- YUCCA SCHIDIGERA / MOJAVE YUCCA
- N/A NOLINA PARRYI / PARRY'S NOLINA
- N/A JUNIPERUS CALIFORNICA / CALIFORNIA JUNIPER
- N/A YUCCA WHIPPLEI / OUR LORD'S CANDLE
- N/A PINUS MONOPHYLLA / PINON PINE

- (E) NATIVE PLANTING TO REMAIN MIX:
- CHIA, SALVIA COLUMBARIAE - VERY FREQUENT, APPROX. 8' SPACING
 - BLACKBRUSH, COLEOGYNE RAMOSISSIMA - VERY FREQUENT, APPROX. 8' SPACING
 - SILVER CHOLLA, CYLINDROPUNTIA ECHINOCARPA - FREQUENT, APPROX. 15' SPACING
 - BEAVERTAIL CACTUS, OPUNTIA BASILARIS - FREQUENT, APPROX. 15' SPACING
 - CREOSOTE BUSH, LARREA TRIDENTATA - FREQUENT, APPROX. 10' SPACING
 - ENGELMANN'S HEDGEHOG CACTUS, ECHINOCEREUS ENGELMANNII - RARE, 4 QTY ON THE ENTIRE PARCEL

PROPOSED LANDSCAPING LEGEND

- AREA OF RESTORATION AT PREVIOUS UNPERMITTED GRADING LOCATIONS
- BEAVERTAIL CACTUS
- BLACKBRUSH
- CREOSOTE BUSH
- CHIA - SALVIA COLUMBARIAE
- SILVER CHOLLA
- ENGELMANN'S HEDGEHOG CACTUS

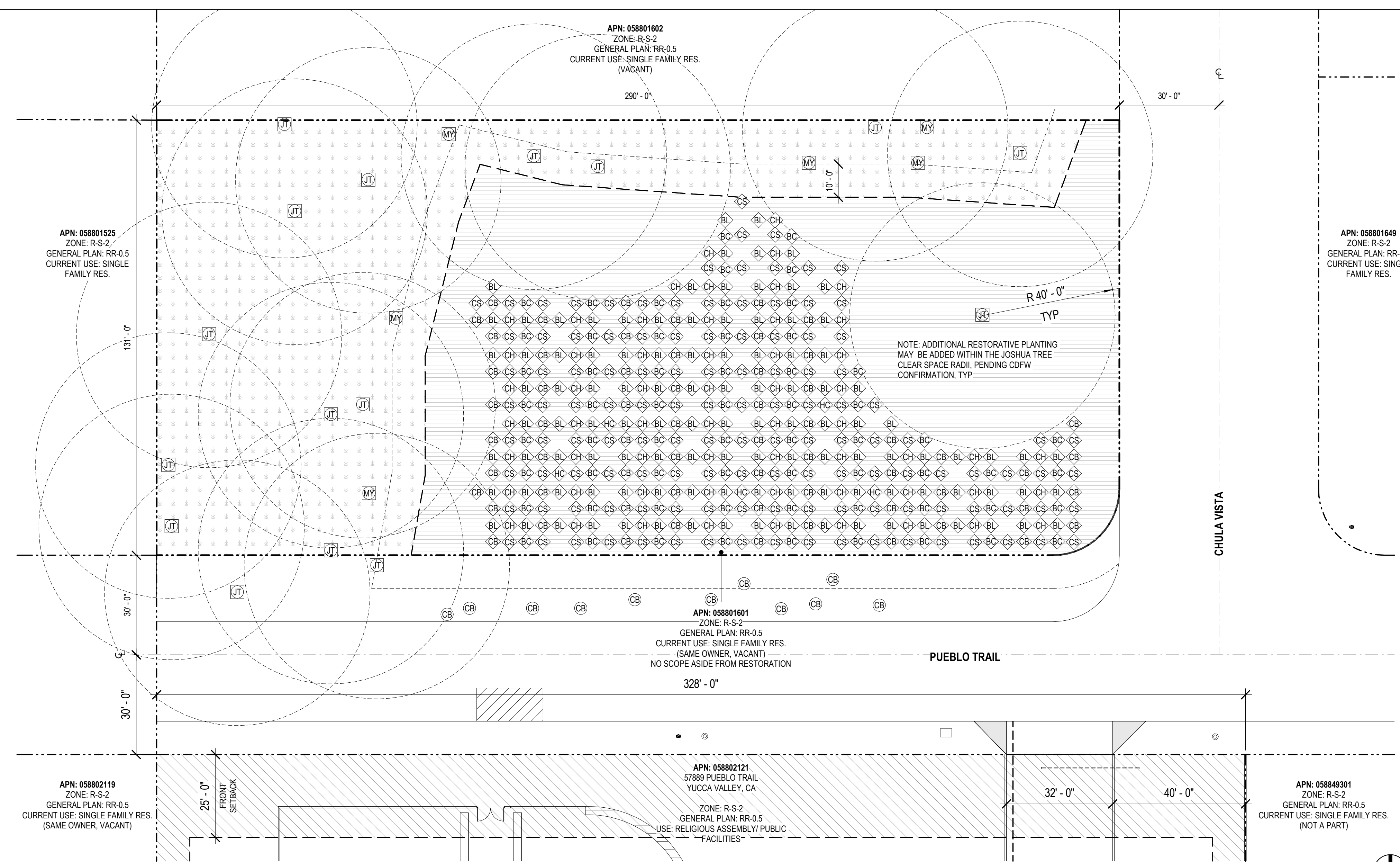

NATIVE PLANT & RESTORATION PLAN - APN 058801601
1" = 20'-0" **02**



VICINITY MAP APN 058801601 EXHIBIT B
1" = 200'-0" **01**

NATIVE PLANT PLAN NOTES

ALL EXISTING PLANTINGS TO REMAIN. PLEASE REFER TO BIOLOGICAL REPORT FOR A MORE DETAILED DISCUSSION OF THE VARIOUS PLANT SPECIES OBSERVED DURING THE SURVEYS.

OFFICIAL USE ONLY

PROPOSED NATIVE LANDSCAPE SCREENING

- ◊ DESERT WILLOW
- ⊕ CREOSOTE BUSH
- ⊕ SUGAR BUSH

PROJECT SCOPE

A CONDITIONAL USE PERMIT (CUP) TO ALLOW NON-RELIGIOUS ASSEMBLY RELATED TO EVENTS HOSTED THE EXISTING FACILITY AND GROUNDS AT APNS 058802121, 058802128, 058802129, 058801601

LEGAL DESCRIPTION

SITE ADDRESS: 57889 PUEBLO TRAIL, YUCCA VALLEY, CA 92284
LAND USE DISTRICT: RURAL RESIDENTIAL (RR-0.5) 0.5 AC MIN
ZONING DISTRICT: R-S-2
 APN: 058802121, 058802128, 058802129, 058801601 (RESTORATION PLANTING ONLY)
APPLICANT: HIGH DESERT CENTER, LLC, 5925 N. MINA VISTA AVE TUCSON, AZ 85718, (760) 646-0642
PREPARATION DATE: 06/25/2025

(E) TO REMAIN NATIVE PLANT LEGEND

- Ⓜ YUCCA BREVIFOLIA / WESTERN JOSHUA TREE
- Ⓜ YUCCA BREVIFOLIA / WESTERN JOSHUA TREE (DEAD)
- Ⓜ YUCCA SCHIDIGERA / MOJAVE YUCCA
- N/A NOLINA PARRYI / PARRY'S NOLINA
- N/A JUNIPERUS CALIFORNICA / CALIFORNIA JUNIPER
- N/A YUCCA WHIPPLEI / OUR LORD'S CANDLE
- N/A PINUS MONOPHYLLA / PINON PINE

(E) TO REMAIN LANDSCAPING LEGEND

- AC ACACIA TREE - QTY:5
- AG AGAVE - QTY:6
- AS AUTUMN SAGE - QTY:4
- BR BARREL CACTUS - QTY:4
- BG BEAR GRASS - QTY:7
- BC BEAVERTAIL CACTUS - QTY:17
- BT BUTTERFLY TREE - QTY:10
- CB CREOSOTE BUSH - QTY:10
- CH CHOLLA, SILVER - QTY:2
- DB DESERT BROOM - QTY:1
- DW DESERT WILLOW - QTY:3
- DY DAISY - QTY:
- EU EUCLALPTUS - QTY:8
- HC HEDGEHOG CACTUS - QTY:7
- LA LAVENDER - QTY:25
- MT MESQUITE TREE - QTY:26
- MX MEXICAN BIRD OF PARADISE - QTY:3
- OC OCOTILLO - QTY: 7
- OP ORGAN PIPE CACTUS - QTY:1
- PC PENCIL CHOLLA - QTY:19
- PP PRICKLY PEAR CACTUS - QTY:2
- PE PEPPER TREE - QTY:1
- PT POMEGRANATE TREE - QTY:1
- PA PALM TREE - QTY:2
- RB ROSE BUSH - QTY:2
- RS RUSSIAN SAGE - QTY:7
- RO ROSEMARY - QTY:32
- SA SHOESTRING ACACIA - QTY:1
- SG SAND GOLDEN HEATER - QTY:1
- SM SUMAC - QTY:7
- SO SAGUARO - QTY:3
- ST SACAHUISTA - QTY:4
- TS TEXAS SAGE - QTY:17

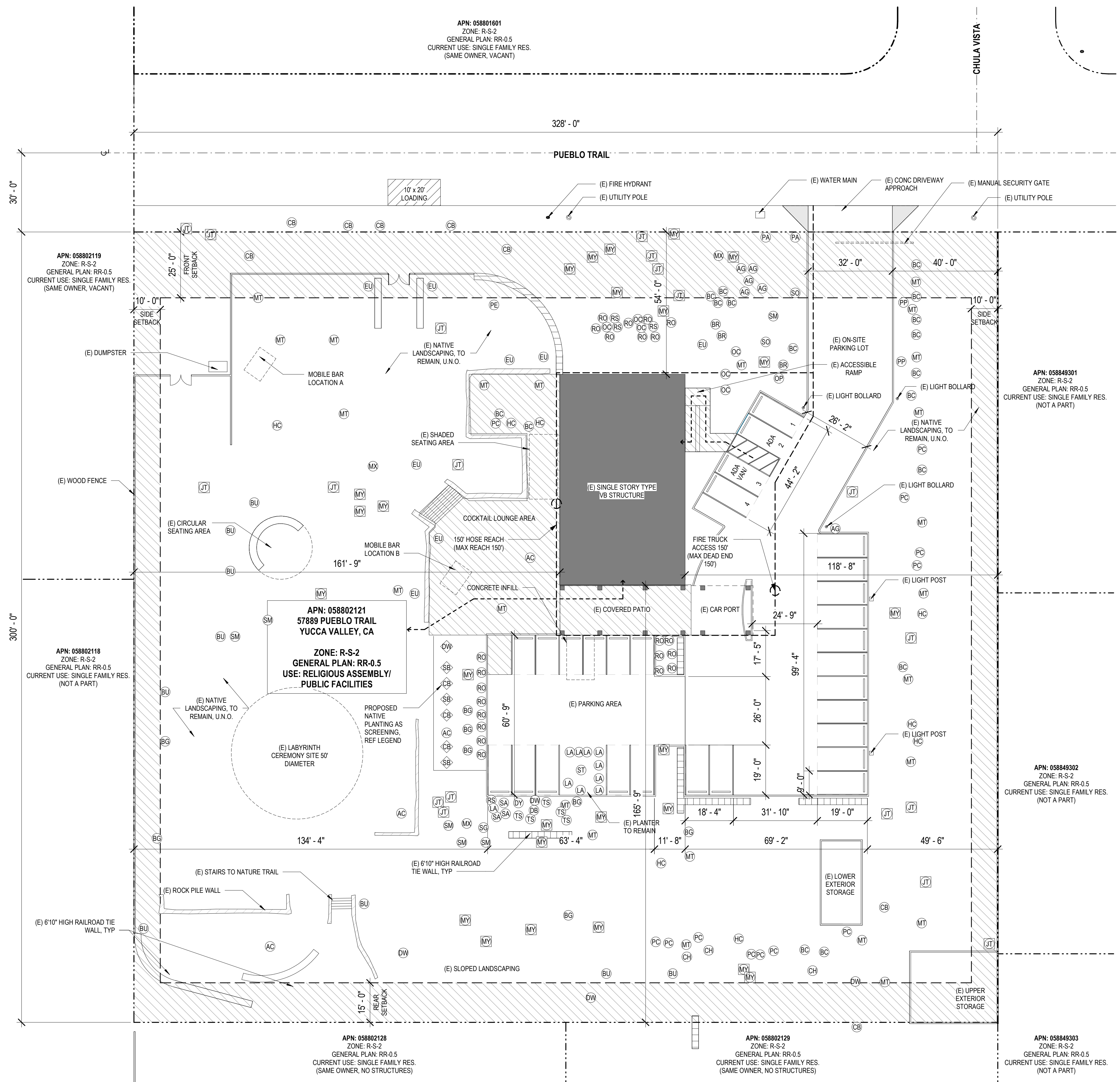

NATIVE PLANT & LANDSCAPING PLAN - APN 058802121
 1" = 20'-0" **02**

VICINITY MAP APN 058802121 EXHIBIT B
 1" = 200'-0" **01**

NATIVE PLANT PLAN NOTES

ALL EXISTING PLANTINGS TO REMAIN. PLEASE REFER TO BIOLOGICAL REPORT FOR A MORE DETAILED DISCUSSION OF THE VARIOUS PLANT SPECIES OBSERVED DURING THE SURVEYS.

OFFICIAL USE ONLY

PROJECT SCOPE

A CONDITIONAL USE PERMIT (CUP) TO ALLOW NON-RELIGIOUS ASSEMBLY RELATED TO EVENTS HOSTED AT THE EXISTING FACILITY AND GROUNDS AT APNS 058802121, 058802128, 058802129

LEGAL DESCRIPTION

SITE ADDRESS: 57889 PUEBLO TRAIL, YUCCA VALLEY, CA 92284

LAND USE DISTRICT: RURAL RESIDENTIAL (RR-0.5) 0.5 AC MIN
ZONING DISTRICT: R-S-2

APN: 058802121, 058802128, 058802129, 058801601 (RESTORATION PLANTING ONLY)

APPLICANT: HIGH DESERT CENTER, LLC, 5925 N. MINA VISTA AVE
TUCSON, AZ 85718, (760) 646-0642

PREPARATION DATE: 06/25/2025

(E) TO REMAIN NATIVE PLANT LEGEND

- YUCCA BREVIFOLIA / WESTERN JOSHUA TREE
- YUCCA BREVIFOLIA / WESTERN JOSHUA TREE (DEAD)
- YUCCA SCHIDIGERA / MOJAVE YUCCA
- N/A NOLINA PARRYI / PARRY'S NOLINA
- N/A JUNIPERUS CALIFORNICA / CALIFORNIA JUNIPER
- N/A YUCCA WHIPPLEI / OUR LORD'S CANDLE
- N/A PINUS MONOPHYLLA / PINON PINE

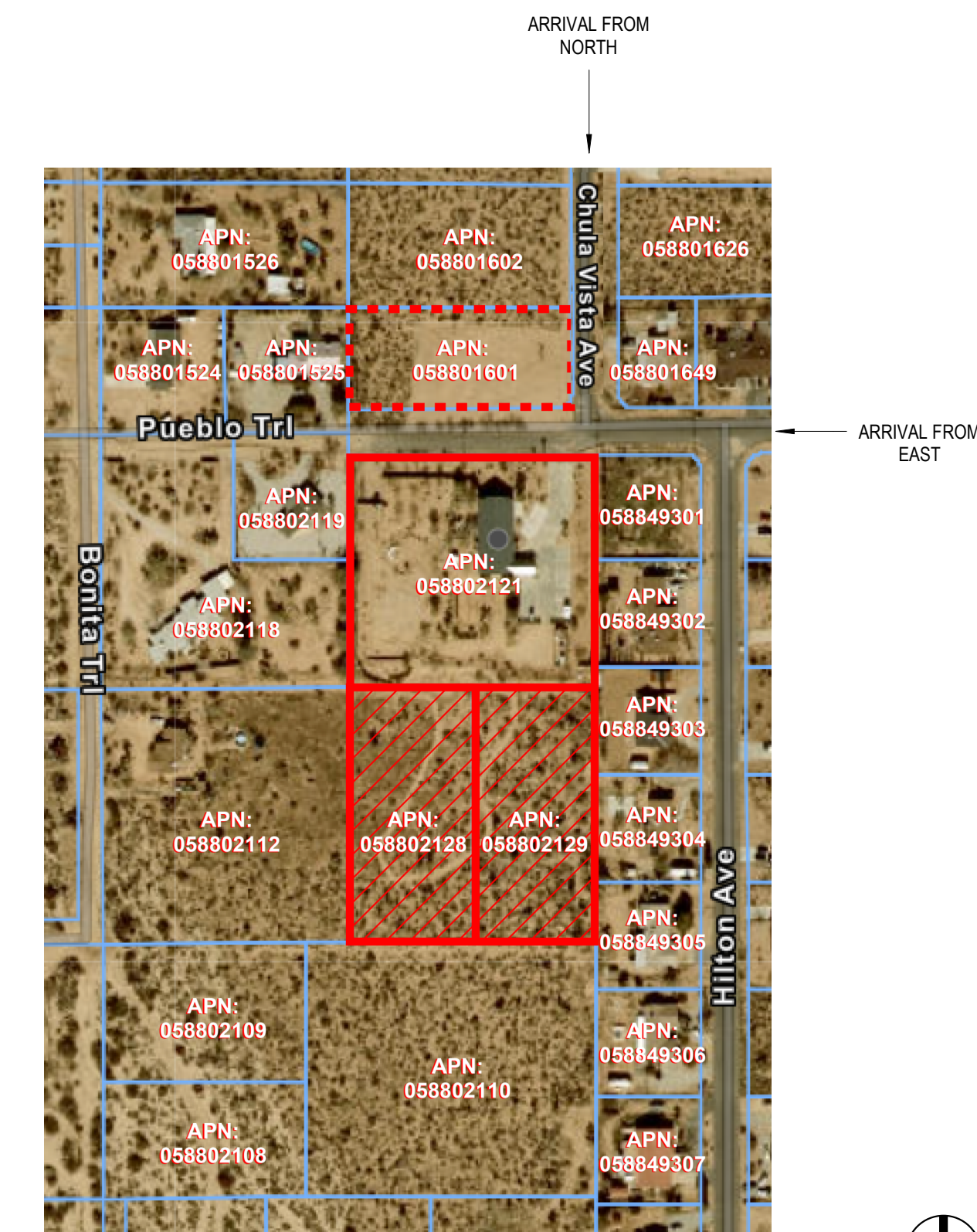

NATIVE PLANT PLAN - APN 058802128 & 9
1" = 20'-0" **02**

VICINITY MAP APN 058802128 & 9 EXHIBIT B
1" = 200'-0" **01**

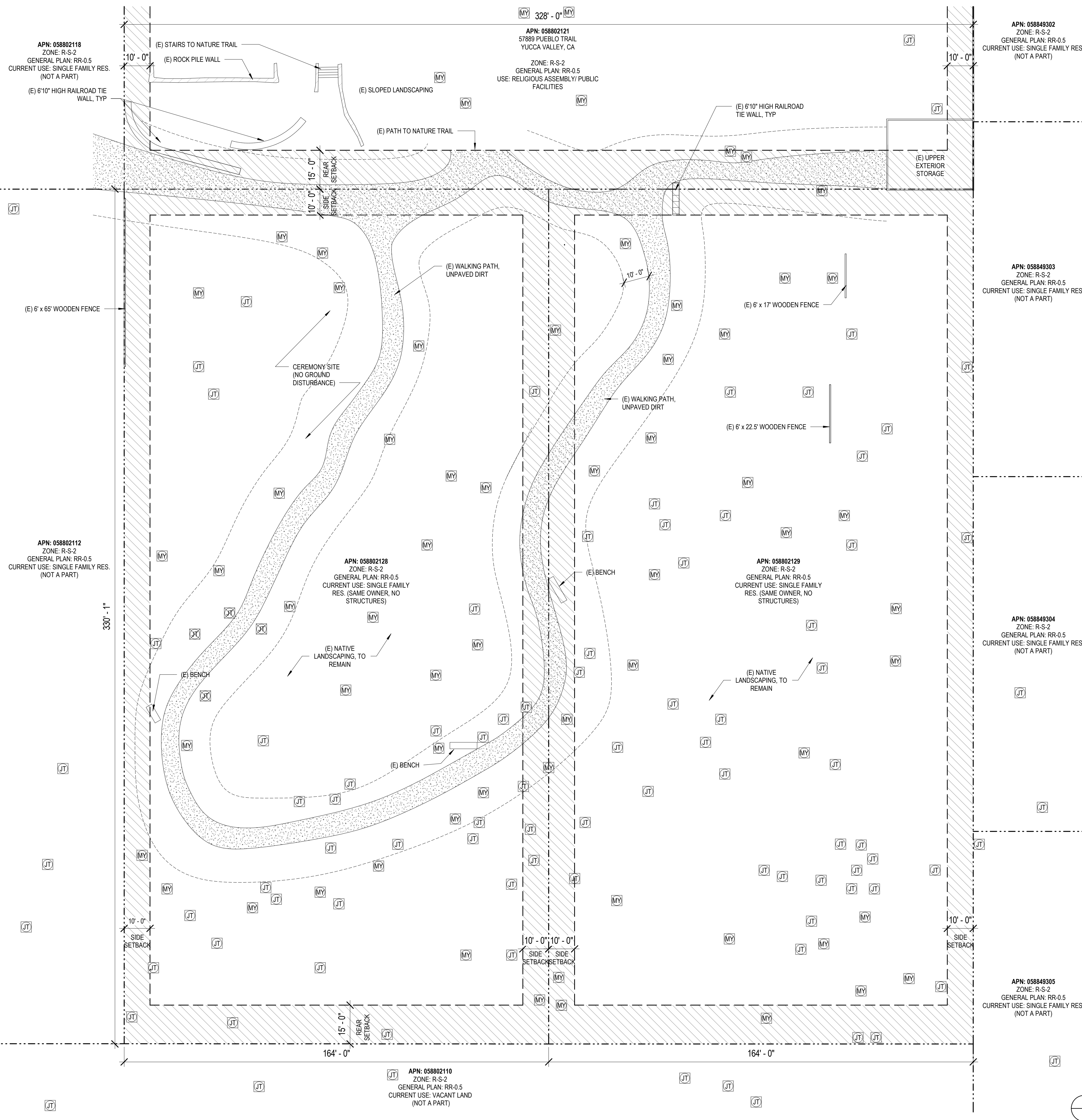

EXHIBIT B

A5

TUMBLEWEED SANCTUARY - CUP
57889 PUEBLO TRAIL, 92284
SCALE AT 24 X 36:
As Indicated
6/25/2025 12:41:14 PM