



Know what's below.
Call before you dig.
Dial 811

DUTCH BROS. COFFEE - CA3714 - YUCCA VALLEY, CA PRELIMINARY GRADING AND DRAINAGE PLAN

PROJECT DATA

NAME: DUTCH BROS COFFEE - CA3714 - YUCCA VALLEY, CA
PARCEL AREA: 44,190 SF (1.014 ACRES)
DISTURBED PROJECT AREA: 48,127 SF (1.1 ACRES)
PARCEL #: 0601-416-05
ZONE: MIXED USE COMMERCIAL (C-MU)
GENERAL PLAN DESIGNATION: COMMERCIAL
QUEING: 23 VEHICLES

BASIS OF BEARINGS:

THE BEARING BEARINGS N 53° 33' 05" E ALONG BALSAS AVENUE AS SHOWN ON PARCEL MAP NO. 15502, FILED IN BOOK 193, PAGES 98 AND 99 OF PARCEL MAPS.

EASEMENT NOTES

- 5' EASEMENT(S) FOR ELECTRIC AND TELEPHONE FACILITIES AND RIGHT INCIDENTAL THERETO, AS GRANTED IN A DOCUMENT TO CALIFORNIA WATER & TELEPHONE COMPANY RECORDED MARCH 30, 1962, IN BOOK 5672, PAGE 78, OFFICIAL RECORDS.
- MATTERS CONTAINED IN THAT CERTAIN DOCUMENT ENTITLED RECIPROCAL EASEMENT AGREEMENT DATED OCTOBER 3, 2000, EXECUTED BY JOSEPH A. SIROLA AND THOMAS A. KELLER, III ET AL RECORDED OCTOBER 20, 2000, RECORDING NO. 20000381189, OFFICIAL RECORDS.
- EASEMENT(S) FOR UNDERGROUND COMMUNICATION FACILITIES AND RIGHTS INCIDENTAL THERETO, AS GRANTED IN A DOCUMENT TO VERIZON CALIFORNIA INC., A CALIFORNIA CORPORATION RECORDED FEBRUARY 1, 2002, RECORDING NO. 20020054622, OFFICIAL RECORDS.
- 20' EASEMENT(S) FOR SEWER EASEMENT AND RIGHTS INCIDENTAL THERETO, AS GRANTED IN A DOCUMENT TO HI DESERT WATER DISTRICT, A PUBLIC AGENCY OF THE STATE OF CALIFORNIA RECORDED AUGUST 21, 2015, RECORDING NO. 2015-0360067, OFFICIAL RECORDING.

LEGAL DESCRIPTION

THE LAND REFERRED TO HEREIN BELOW IS SITUATED IN THE CITY OF YUCCA VALLEY, COUNTY OF SAN BERNARDINO, STATE OF CALIFORNIA AND IS DESCRIBED AS FOLLOWS:

PARCEL ONE:

PARCEL 4 OF PARCEL MAP NO. 15502, IN THE TOWN OF YUCCA VALLEY, COUNTY OF SAN BERNARDINO, STATE OF CALIFORNIA, AS PER MAP FILED IN BOOK 193, PAGES 98 AND 99 OF PARCEL MAPS, IN THE OFFICE OF THE COUNTY RECORDER OF SAID COUNTY.

PARCEL TWO:

A NON-EXCLUSIVE EASEMENT FOR REASONABLE PEDESTRIAN AND VEHICULAR ACCESS, INGRESS AND EGRESS AS SET FORTH AND DEFINED AS EASEMENT DRIVEWAY IN RECIPROCAL EASEMENT AGREEMENT RECORDED OCTOBER 20, 2000, INSTRUMENT NO. 2000-381189, OF OFFICIAL RECORDS

APN: 0601-416-05

THE LAND SHOWN IN THIS SURVEY IS THE SAME AS THAT DESCRIBED IN FIDELITY NATIONAL TITLE COMPANY, COMMITMENT NO. FCH2400711NT WITH AN EFFECTIVE DATE OF AUGUST 22, 2024 AT 7:30 AM

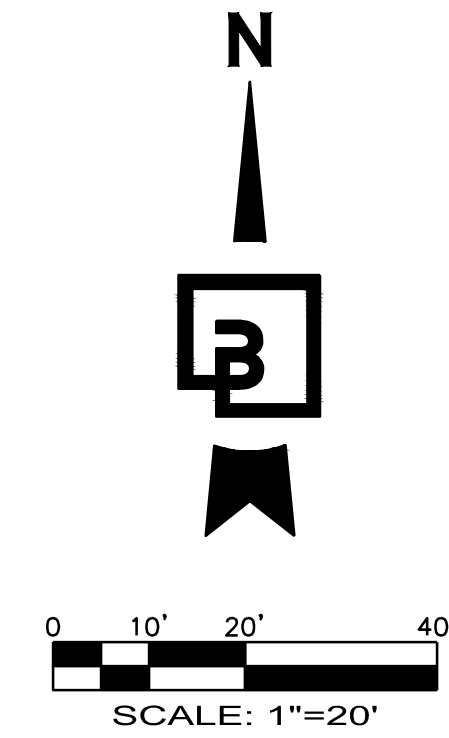
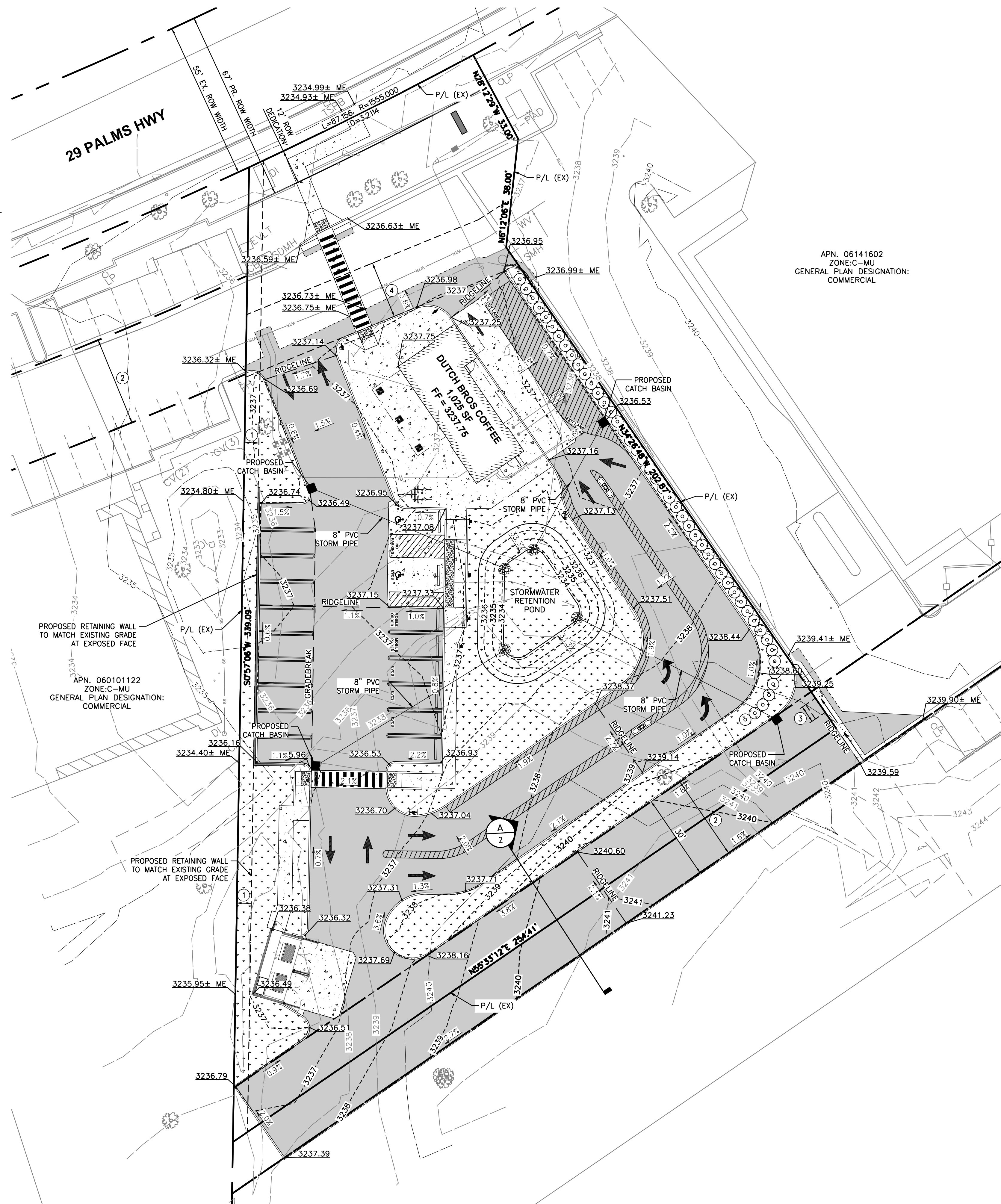

APN: 06141602
ZONE: C-MU
GENERAL PLAN DESIGNATION:
COMMERCIAL

GRADING GENERAL NOTES:

- ALL GRADING SHALL BE CONSTRUCTED IN ACCORDANCE WITH THE PROVISIONS OF THE CURRENT CITY ORDINANCE AND STANDARD PLANS. THE GRADING IS SUBJECT TO THE OBSERVATION AND APPROVAL OF THE PUBLIC WORKS DEPARTMENT.
- CONTRACTOR SHALL BE RESPONSIBLE FOR VERIFYING ALL PROPOSED GRADES IN RELATIONSHIP TO SURVEYED BASIS OF ELEVATION.
- ALL EXISTING UTILITY STRUCTURES AND ASSOCIATED LIDS THAT FALL WITHIN THE AREA OF WORK SHALL BE ADJUSTED TO FINISHED GRADE ELEVATIONS. CONTRACTOR SHALL CONFIRM THE FEASIBILITY OF ADJUSTING EXISTING UTILITY STRUCTURE LIDS TO FINISHED GRADE PRIOR TO CONSTRUCTION AND NOTIFY ENGINEER OF ANY DISCREPANCIES.
- CONTRACTOR TO PROTECT AND MAINTAIN EROSION CONTROL FACILITIES DURING GRADING OPERATIONS.
- CONTRACTOR TO OBTAIN ANY NECESSARY RIGHT-OF-WAY PERMITS IF REQUIRED FOR WORK SHOWN ON PLANS.
- CONTRACTOR SHALL MATCH EXISTING ELEVATIONS AT ALL SAWCUT LOCATIONS.
- ALL SPOT ELEVATIONS SHOWN ARE TO FINISH SURFACE (TOP OF ASPHALT OR TOP OF CONCRETE PAVEMENT, NOT TOP OF CURB/SIDEWALK) UNLESS OTHERWISE NOTED.

GRADING PLAN LEGEND:

FF - FINISHED FLOOR
ME - MATCH EXISTING
LP - LOW POINT

UTILITY POTHOLING NOTE:

THE CIRCLED LOCATIONS ARE REQUIRED TO BE POTHOLED TO VERIFY VERTICAL AND HORIZONTAL LOCATION OF EXISTING UTILITY AND/OR POTENTIAL CONFLICTS WITH EXISTING UTILITIES. POTHOLING SHALL BE PERFORMED PRIOR TO INSTALLING ANY PROPOSED UTILITIES. CONTRACTOR SHALL NOTIFY BARGHAUSEN CONSULTING ENGINEERS, INC. OF ANY CONFLICTS.

OWNER

CONTACT: CHRIS PETO
5TH STREET DEVELOPMENT, LLC
1011 CAMINO DEL MAR #258
DEL MAR, CA 92014
TEL: (310) 346-0379
EMAIL: CPETO@HALFERTY.COM

ENGINEER

BARGHAUSEN CONSULTING ENGINEERS, LLC
18215 72ND AVE. SOUTH
KENT, WA 98032
TEL: (425) 251-6222
CONTACT: HAL P. GRUBB, P.E.
EMAIL: HGRUBB@BARGHAUSEN.COM
WEBSITE: HTTPS://WWW.BARGHAUSEN.COM

GEOTECHNICAL

INLAND ENGINEERING TECHNOLOGIES INC.
41555 REAGAN HWY. SITE E
MURRIETA, CA 92562
TEL: (951) 894-6464
CONTACT: JAMES WORLEY
WEBSITE: HTTPS://WWW.INLANDTECHNOLOGIES.NET

DEVELOPER

DUTCH BROS COFFEE
P.O. BOX 1929
GRANTS PASS, OR 97528
CONTACT: JOHN CAGLIA
TEL: (714) 883-9092
EMAIL: JOHN.CAGLIA@DUTCHBROS.COM
WEBSITE: HTTPS://WWW.DUTCHBROS.COM

SURVEYOR

RIGHTIG CORP.
13911 NOWATA CT
APPLE VALLEY, CA 92307
TEL: (833) 907-5082
EMAIL: CHRIS@RIGHTIGCORP.COM

ESTIMATED EARTHWORK QUANTITIES:

CUT: 1000 CY
FILL: 200 CY
NET: 800 CY
AREA TO BE DISTURBED = 1.1 ACRES

- THE QUANTITIES LISTED ARE FOR PERMITTING PURPOSES ONLY.
- THE QUANTITIES LISTED INCLUDE PRELIMINARY PROPOSED PAVING SECTIONS.
- EARTHWORK QUANTITIES ARE APPROXIMATE AND DO NOT ACCOUNT FOR CLEARING AND GRUBBING, TRENCHING, OR OVER EXCAVATION ETC. AS REQUIRED BY THE GEOTECHNICAL REPORT.
- THE CONTRACTOR IS RESPONSIBLE TO VERIFY EXISTING SITE CONDITIONS AND CALCULATE THEIR OWN EARTH WORK QUANTITIES FOR THE PROJECT PRIOR TO BID

CONTRACTOR SHALL REFER TO THE GEOTECHNICAL INVESTIGATION REPORT FOR THIS SITE DATED: TBD
PREPARED BY: INLAND TECHNOLOGIES INC.

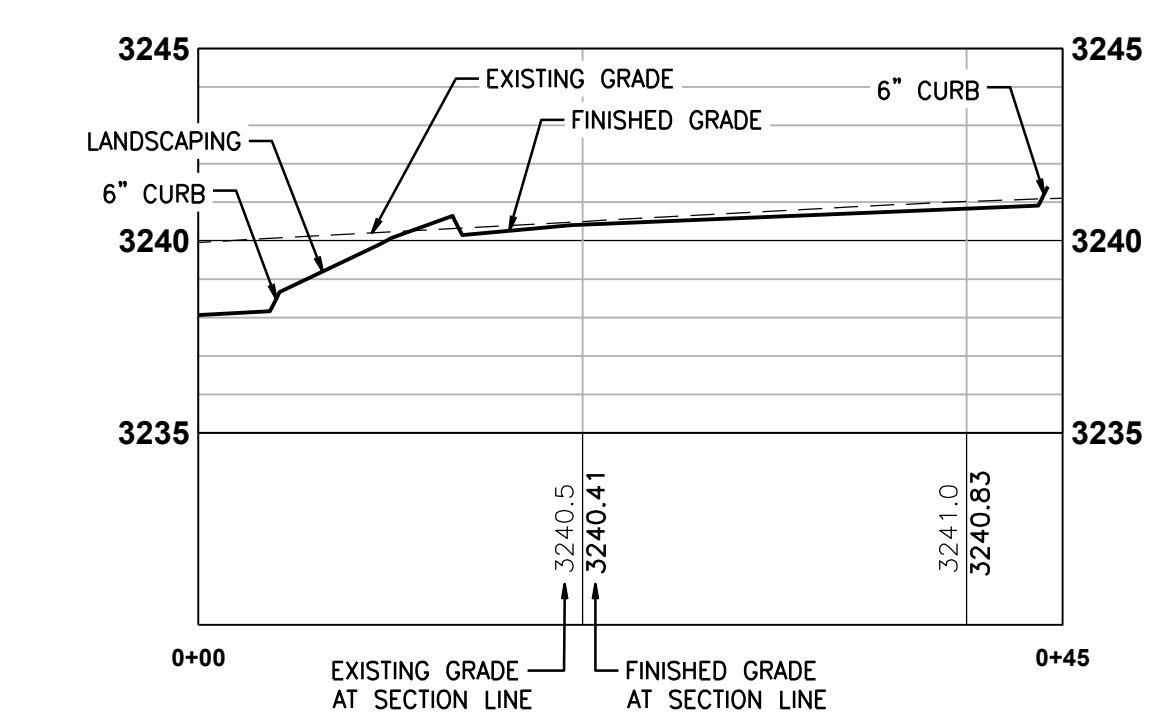

ROADWAY CROSS SECTION
SCALE: 1"=10'H, 1"=5'V

LEGEND	
BUILDING LINE	//////
EXISTING CURB TO REMAIN	=====
PROPOSED CURB	=====
PROPOSED LANDSCAPING
PROPOSED ASPHALT	=====
PROPOSED CONCRETE

PRELIMINARY NOT FOR CONSTRUCTION

TITLE: PRELIMINARY GRADING AND DRAINAGE PLAN
 SWQ 29 PALMS HWY & BALSAS AVE
 YUCCA VALLEY, CA

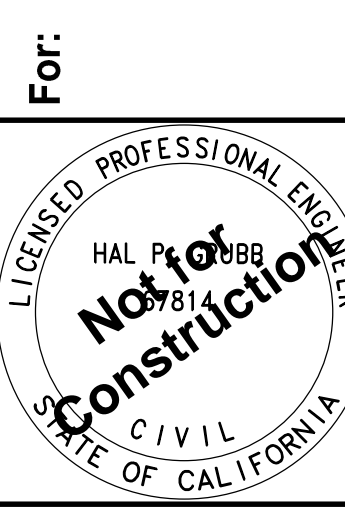
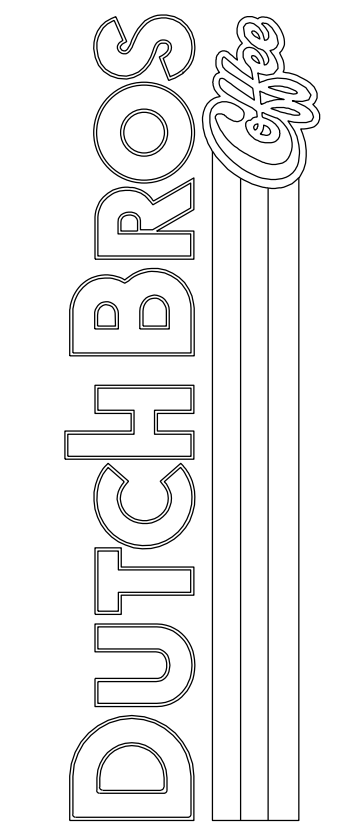

Scale: Horizontal 1" = 20', Vertical N/A
Designed: RG, Draw: LW, Checked: AEM, Approved: HPG, Date: 4/23/25

Barghausen Consulting Engineers, LLC.
18215 72nd Avenue South
Kent, WA 98032
425.251.6222
barghausen.com

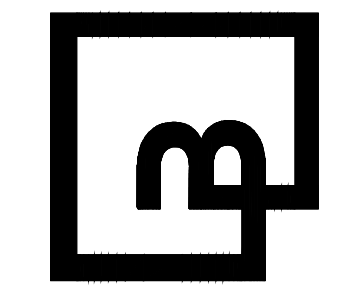

Job Number: 23690
Sheet: 2 OF 2
2019 DB
Franchising USA, LLC

The name DUTCH BROS, and all associated logos, distinctive designs, content, information, and other materials featured, displayed, contained herein, and made available by Dutch Bros., including but not limited to, the "look and feel" of the establishments and products, all text, images, colors, configurations, graphics, designs, illustrations, photographs, and pictures (collectively, the "Materials") are owned by and/or licensed by DB Franchising USA, LLC and are protected by copyright, trademark, trade dress, patent, and/or other intellectual property rights under the United States and foreign laws.

NV24RCH1UK
 4/23/2025 3:36 PM
 P:\23000s\23690\preliminary\23690-04.dwg