

SITE ANALYSIS TABLE		
FUEL STATION ADDRESS	58501 TWENTY NINE PALMS HWY, YUCCA VALLEY, CA 92284	
CURRENT ZONING	CG - GENERAL COMMERCIAL	
EXISTING PARCEL AREA	23.85 ACRES	
EXISTING WALMART BUILDING AREA	184,146 S.F.	
PROPOSED FUEL AREA	1.32 ACRES	
PROPOSED FUEL BUILDING AREA	1,556 S.F.	
	PARKING COUNT	PARKING RATIO
EXISTING TOTAL PARKING	905 SPACES	4.91/1,000 S.F.
EXISTING STANDARD STALLS	873 SPACES	---
EXISTING ADA STALLS	32 SPACES	---
EXISTING CART CORRAL STALLS*	38 SPACES	---
PROPOSED TOTAL PARKING	785 SPACES	4.26/1,000 S.F.
PROPOSED STANDARD STALLS	752 SPACES	---
PROPOSED ADA STALLS	33 SPACES	---
PROPOSED CART CORRAL SPACES*	31 SPACES	---
CITY REQ. PARKING	737 SPACES	1.00/250 S.F.
WALMART REQ. PARKING	737 SPACES	4.00/1,000 S.F.

NOTE:
 1. * CART CORRAL STALLS ARE NOT INCLUDED IN ANY PARKING RATIO CALCULATION.

LEGEND	
	PROPERTY LINE
	HEAVY DUTY ASPHALT PAVING
	LANDSCAPING
	CONCRETE SIDEWALK
	CONCRETE PAVEMENT
	TRUNCATED DOMES

- CONSTRUCTION NOTES**
- PROPOSED CONCRETE CURB.
 - PROPOSED HEAVY DUTY ASPHALT PAVEMENT.
 - PROPOSED CONCRETE PAVEMENT.
 - STRIPE DIRECTIONAL ARROW PAVEMENT MARKING.
 - STRIPE STOP BAR PAVEMENT MARKING.
 - STRIPE WHITE 4" STRIPE, 60 DEGREES, SPACED AT 36" O.C.
 - PROPOSED LANDSCAPING.
 - PROPOSED 1,440 SF CONVENIENCE STORE.
 - PROPOSED UNDERGROUND GAS TANKS, ONE 20,000 GAL UNL, ONE 20,000 GAL SPLIT (12,000 UNL/8,000 PRM), AND ONE 20,000 GAL DSL.
 - PROPOSED AIR STATION.
 - PROPOSED CANOPY.
 - PROPOSED TRUNCATED DOMES.
 - PROPOSED VAN ACCESSIBLE PARKING SIGN ON POST.
 - PROPOSED VAN ACCESSIBLE PARKING.
 - PROPOSED PEDESTRIAN CROSSING SIGN ON POST AND BOLLARD.
 - PROPOSED CONCRETE SIDEWALK.
 - PROPOSED PATH OF TRAVEL STRIPING.
 - PROPOSED TRASH ENCLOSURE.
 - PROPOSED REGULAR PARKING.
 - PROPOSED PEDESTRIAN CROSSING SIGN ON POST.
 - PROPOSED CURB AND GUTTER.
 - PROPOSED VALLEY GUTTER.
 - PROPOSED STOP SIGN ON POST.
 - PROPOSED SUPPLEMENTARY "CROSS TRAFFIC DOES NOT STOP" PLACARD.
 - PROPOSED TRANSFORMER PAD SHOWN FOR REFERENCE ONLY.

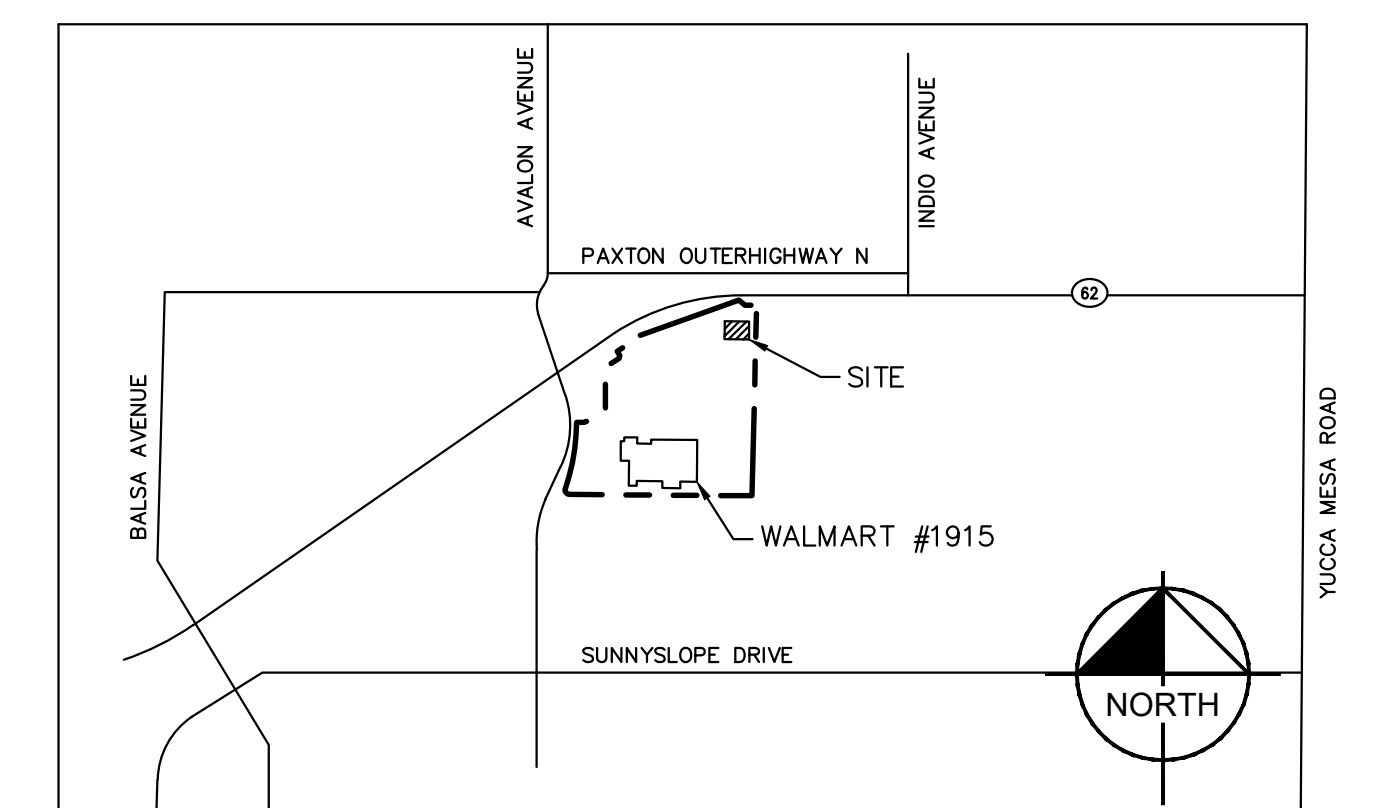

WALMART FUEL STATION - STORE #1915
58501 TWENTY NINE PALMS HWY., YUCCA VALLEY, CA 92284
DESIGN CIVIL SITE PLAN

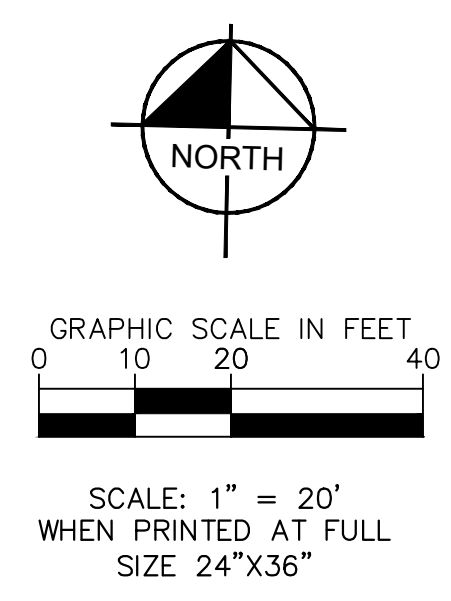

VICINITY MAP
N.T.S.